

---

## AHERA Operations & Management Plan Revision Notes

# **Periodic Surveillance**





**SIX – MONTH PERIODIC SURVEILLANCE**  
**Edmonson County Schools– Project #991730**

*Air Source Technology, Inc.*

BUILDING NAME: Old Bus Garage (999)

INSPECTOR'S NAME: Chris Adkins

DATE: 5/10/13

Has Inspector had training? (Y) \_\_\_\_\_ (N) \_\_\_\_\_

Are warning signs in place? (N/A) \_\_\_\_\_ (Y) \_\_\_\_\_ (N) \_\_\_\_\_

ACBM	HA#	LOCATION	CONDITION	Type of ACBM
1. Linoleum		Office A & B	Good Condition	Assumed

Comments: This facility is being used for storage only and replaced by new bus facility.

5/10/13

Signature of Inspector

Date



**SIX – MONTH PERIODIC SURVEILLANCE**  
**Edmonson County Schools– Project #991730**

*Air Source Technology, Inc.*

BUILDING NAME: Old Bus Garage (999)

INSPECTOR'S NAME: Chris Adkins

TIME: 9:30 AM

DATE: 10/30/12

Has Inspector had training? (Y) \_\_\_\_\_ (N) \_\_\_\_\_

Are warning signs in place? (N/A) \_\_\_\_\_ (Y) \_\_\_\_\_ (N) \_\_\_\_\_

ACBM	HA#	LOCATION	CONDITION	Type of ACBM
1. Linoleum		Office A & B	Good Condition	Assumed

Comments: This facility is being used for storage only and replaced by new bus facility.

*Christopher K. Adkins*

10/30/12

Signature of Inspector

Date



**SIX – MONTH PERIODIC SURVEILLANCE**  
**Edmonson County Schools– Project #991730**

*Air Source Technology, Inc.*

BUILDING NAME: Old Bus Garage (999)

INSPECTOR'S NAME: Chris Adkins

TIME: 9:30 AM

DATE: 5/17/12

Has Inspector had training? (Y) \_\_\_\_\_ (N) \_\_\_\_\_

Are warning signs in place? (N/A) \_\_\_\_\_ (Y) \_\_\_\_\_ (N) \_\_\_\_\_

ACBM	HA#	LOCATION	CONDITION	Type of ACBM
1. Linoleum		Office A & B	Good Condition	Assumed

Comments: This facility is being used for storage only and replaced by new bus facility.

Signature of Inspector

5/17/12

Date



**SIX – MONTH PERIODIC SURVEILLANCE**  
**Edmonson County Schools– Project #991730**

*Air Source Technology, Inc.*

BUILDING NAME: Old Bus Garage (999)

INSPECTOR'S NAME: Dan Violette

TIME: 9:30 AM

DATE: 4/28/11

Has Inspector had training? (Y) \_\_\_\_\_ (N) \_\_\_\_\_

Are warning signs in place? (N/A) \_\_\_\_\_ (Y) \_\_\_\_\_ (N) \_\_\_\_\_

ACBM	HA#	LOCATION	CONDITION	Type of ACBM
1. Linoleum		Office A & B	Good Condition	Assumed

Comments: This facility is being used for storage only and replaced by new bus facility.

*Daniel R. Violette*

5/4/11

Signature of Inspector

Date

*Kenneth Demuse*

5-5-11

P.O. Box 55410  
Lexington, Kentucky 40555-5410

**Air Source Technology, Inc.**  
160 Prosperous Place, Suite 201  
Lexington, Kentucky 40509

PHONE: 859-299-0046  
FAX: 859-299-0494



**SIX – MONTH PERIODIC SURVEILLANCE**  
**Edmonson County Schools– Project #991730**

*Air Source Technology, Inc.*

BUILDING NAME: Old Bus Garage (999)

INSPECTOR'S NAME: Chris Adkins

TIME: 9:30 AM

DATE: 11/10/11

Has Inspector had training? (Y) \_\_\_\_\_ (N) \_\_\_\_\_

Are warning signs in place? (N/A) \_\_\_\_\_ (Y) \_\_\_\_\_ (N) \_\_\_\_\_

ACBM	HA#	LOCATION	CONDITION	Type of ACBM
1. Linoleum		Office A & B	Good Condition	Assumed

Comments: This facility is being used for storage only and replaced by new bus facility.

Signature of Inspector

11/14/11

Date



**SIX – MONTH PERIODIC SURVEILLANCE**  
**Edmonson County Schools– Project #991730**

*Air Source Technology, Inc.*

BUILDING NAME: Old Bus Garage (999)

INSPECTOR'S NAME: Chris Adkins

TIME: 9:30 AM

DATE: 11/15/10

Has Inspector had training? (Y) \_\_\_\_\_ (N) \_\_\_\_\_

Are warning signs in place? (N/A) \_\_\_\_\_ (Y) \_\_\_\_\_ (N) \_\_\_\_\_

ACBM	HA#	LOCATION	CONDITION	Type of ACBM
1. Linoleum		Office A & B	Good Condition	Assumed

Comments: This facility is being used for storage only and replaced by new bus facility.

Signature of Inspector

11/16/10

Date

Signature of LEA Designee

11-22-10

Date



**SIX – MONTH PERIODIC SURVEILLANCE**  
**Edmonson County Schools– Project #991730**

*Air Source Technology, Inc.*

BUILDING NAME: Old Bus Garage (999)

INSPECTOR'S NAME: Dan Violette

TIME: 2:00 PM

DATE: 3/18/10

Has Inspector had training? (Y) \_\_\_\_\_ (N) \_\_\_\_\_

Are warning signs in place? (N/A) \_\_\_\_\_ (Y) \_\_\_\_\_ (N) \_\_\_\_\_

ACBM	HA#	LOCATION	CONDITION	Type of ACBM
1. Linoleum		Office A & B	Good Condition	Assumed

Comments: This facility is being used for storage only and replaced by new bus facility.

3/22/10

Signature of Inspector

Date

Signature of LEA Designee

Date



**SIX – MONTH PERIODIC SURVEILLANCE**  
**Edmonson County Schools– Project #991730**

BUILDING NAME: Old Bus Garage (999)

INSPECTOR'S NAME: Dan Violette

TIME: 2:00 PM

DATE: 10/23/09

Has Inspector had training? (Y) \_\_\_\_\_ (N) \_\_\_\_\_

Are warning signs in place? (N/A) \_\_\_\_\_ (Y) \_\_\_\_\_ (N) \_\_\_\_\_

ACBM	HA#	LOCATION	CONDITION	Type of ACBM
1. Linoleum		Office A & B	Good Condition	Assumed

Comments: This facility is being used for storage only and replaced by new bus facility.

*Daniel R. Violette*

11/23/09

Signature of Inspector

Date

*Jamie D. Dussan*

11-30-09

Signature of LEA Designee

Date





**SIX – MONTH PERIODIC SURVEILLANCE**  
**Edmonson County Schools– Project #991730**

**Air Source Technology, Inc.**

BUILDING NAME: Old Bus Garage (999)

INSPECTOR'S NAME: Dan Violette

TIME: 2:00 PM

DATE: 3/19/09

Has Inspector had training? (Y) \_\_\_\_\_ (N) \_\_\_\_\_

Are warning signs in place? (N/A) \_\_\_\_\_ (Y) \_\_\_\_\_ (N) \_\_\_\_\_

ACBM	HA#	LOCATION	CONDITION	Type of ACBM
1. Linoleum		Office A & B	Good Condition	Assumed

Comments: This facility is being used for storage only and replaced by new bus facility.

*Daniel R. Violette*

3/30/09

Signature of Inspector

Date

*Jamie Danner*

4-13-09

Signature of LEA Designee

Date



**SIX – MONTH PERIODIC SURVEILLANCE**  
**Edmonson County Schools– Project #991730**

*Air Source Technology, Inc.*

BUILDING NAME: Old Bus Garage (999)

INSPECTOR'S NAME: Dan Violette

TIME: 2:00 PM

DATE: 10/28/08

Has Inspector had training? (Y) \_\_\_\_\_ (N) \_\_\_\_\_

Are warning signs in place? (N/A) \_\_\_\_\_ (Y) \_\_\_\_\_ (N) \_\_\_\_\_

ACBM	HA#	LOCATION	CONDITION	Type of ACBM
1. Linoleum		Office A & B	Good Condition	Assumed

Comments: This facility is being used for storage only and replaced by new bus facility.

*Daniel R. Violette*

11/4/08

Signature of Inspector

Date

*Kimberly D. Dwyer*

Signature of LEA Designee

11-7-08  
Date



**SIX – MONTH PERIODIC SURVEILLANCE**  
**Edmonson County Schools– Project #991730**

*Air Source Technology, Inc.*

BUILDING NAME: Old Bus Garage (999)

INSPECTOR'S NAME: Dan Violette

TIME: 2:00 PM

DATE: 5/5/08

Has Inspector had training? (Y) \_\_\_\_\_ (N) \_\_\_\_\_

Are warning signs in place? (N/A) \_\_\_\_\_ (Y) \_\_\_\_\_ (N) \_\_\_\_\_

ACBM	HA#	LOCATION	CONDITION	Type of ACBM
1. Linoleum		Office A & B	Good Condition	Assumed

Comments: This facility is being used for storage only and replaced by new bus facility.

*Daniel R. Violette*

5/7/08

Signature of Inspector

Date

*Annice Dumas*

5-12-08

Signature of LEA Designee

Date



**SIX – MONTH PERIODIC SURVEILLANCE**  
**Edmonson County Schools– Project #991730**

*Air Source Technology, Inc.*

BUILDING NAME: Old Bus Garage (999)

INSPECTOR'S NAME: Dan Violette

TIME: 2:00 PM

DATE: 10-19-07

Has Inspector had training? (Y) \_\_\_\_\_ (N) \_\_\_\_\_

Are warning signs in place? (N/A) \_\_\_\_\_ (Y) \_\_\_\_\_ (N) \_\_\_\_\_

ACBM	HA#	LOCATION	CONDITION	Type of ACBM
1. Linoleum		Office A & B	Good Condition	Assumed

Comments: This facility is being used for storage only and replaced by new bus facility.

*Daniel R. Violette*

10-25-07

Signature of Inspector

Date

*Annis Denise*

10-29-07

Signature of LEA Designee

Date



**SIX – MONTH PERIODIC SURVEILLANCE**  
**Edmonson County Schools– Project #991730**

*Air Source Technology, Inc.*

BUILDING NAME: Old Bus Garage (999)

INSPECTOR'S NAME: Dan Violette

TIME: 2:00 PM

DATE: 3-15-07

Has Inspector had training? (Y) \_\_\_\_\_ (N) \_\_\_\_\_

Are warning signs in place? (N/A) \_\_\_\_\_ (Y) \_\_\_\_\_ (N) \_\_\_\_\_

ACBM	HA#	LOCATION	CONDITION	Type of ACBM
1. Linoleum		Office A & B	Good Condition	Assumed

Comments: This facility is being used for storage only and replaced by new bus facility.

3-26-07

Signature of Inspector

Date

Signature of LEA Designee

Date



**SIX – MONTH PERIODIC SURVEILLANCE**  
**Edmonson County Schools– Project #991730**

***Air Source Technology, Inc.***

BUILDING NAME: Bus Garage (999)

INSPECTOR'S NAME: Dan Violette

TIME: 2:00 PM

DATE: 10-23-06

Has Inspector had training? (Y) \_\_\_\_\_ (N) \_\_\_\_\_

Are warning signs in place? (N/A) \_\_\_\_\_ (Y) \_\_\_\_\_ (N) \_\_\_\_\_

ACBM	HA#	LOCATION	CONDITION	Type of ACBM
1. Linoleum		Office A & B	Good Condition	Assumed
2.				

Comments: This facility is being used for storage only and replaced by new bus facility.

*Daniel R. Violette*

10-25-06

Signature of Inspector

Date

*Kennie L. Luce*

Signature of LEA Designee

10-30-06  
Date



# SIX-MONTH PERIODIC SURVEILLANCE EDMONSON COUNTY SCHOOLS

BUILDING NAME: Bus Garage (999)

INSPECTOR'S NAME: Dan Violette

TIME: 2:00 PM

DATE: 4-18-06

Has Inspector had training? (Y) \_\_\_\_\_ (N) \_\_\_\_\_

Are warning signs in place? (N/A) \_\_\_\_\_ (Y) \_\_\_\_\_ (N) \_\_\_\_\_

ACBM	HA#	LOCATION	CONDITION	Type of ACBM
1. Linoleum		Office A & B	Good Condition	Assumed
2.				

Comments: This facility is being used for storage only and replaced by new bus facility.

*Daniel R. Violette*

4-19-06

Signature of Inspector

Date

*Annice Demuse*

4-25-06

Signature of LEA Designee

Date



# SIX-MONTH PERIODIC SURVEILLANCE EDMONSON COUNTY SCHOOLS

BUILDING NAME: Bus Garage (999)

INSPECTOR'S NAME: Dan Violette

TIME: 3:30 PM

DATE: 10-26-05

Has Inspector had training? (Y) \_\_\_\_\_ (N) \_\_\_\_\_

Are warning signs in place? (N/A) \_\_\_\_\_ (Y) \_\_\_\_\_ (N) \_\_\_\_\_

ACBM	HA#	LOCATION	CONDITION	Type of ACBM
1. Linoleum		Office A & B	Good Condition	Assumed
2.				

Comments: This facility is being used for storage only and replaced by new bus facility.



10-27-05

Signature of Inspector

Date



11-1-05

Signature of LEA Designee

Date





# SIX-MONTH PERIODIC SURVEILLANCE EDMONSON COUNTY SCHOOLS

BUILDING NAME: Bus Garage (999)

INSPECTOR'S NAME: Dan Violette

TIME: 3:30 PM

DATE: 4-14-05

Has Inspector had training? (Y) \_\_\_\_\_ (N) \_\_\_\_\_

Are warning signs in place? (N/A) \_\_\_\_\_ (Y) \_\_\_\_\_ (N) \_\_\_\_\_

ACBM	HA#	LOCATION	CONDITION	Type of ACBM
1. Linoleum		Office A & B	Good Condition	Assumed
2.				

Comments: This facility is being used for storage.

*Daniel R. Violette*

5-2-05

Signature of Inspector

Date

5-10-05

Signature of LEA Designee

Date



# SIX-MONTH PERIODIC SURVEILLANCE EDMONSON COUNTY SCHOOLS

BUILDING NAME: Bus Garage (999)

INSPECTOR'S NAME: Dan Violette

TIME: 3:30 PM

DATE: 10-8-04

Has Inspector had training? (Y) \_\_\_\_\_ (N) \_\_\_\_\_

Are warning signs in place? (N/A) \_\_\_\_\_ (Y) \_\_\_\_\_ (N) \_\_\_\_\_

ACBM	HA#	LOCATION	CONDITION	Type of ACBM
1. Linoleum		Office A & B	Good Condition	Assumed
2.				

Comments: This facility is being used for storage.

*Daniel R. Violette*

10-13-04

Signature of Inspector

Date

*Laurie Demarce*

10-21-04

Signature of LEA Designee

Date



# SIX-MONTH PERIODIC SURVEILLANCE EDMONSON COUNTY SCHOOLS

BUILDING NAME: Bus Garage (999)

INSPECTOR'S NAME: M. Dona Thakurdas

TIME: 11:15 AM

DATE: 4-22-04

Has Inspector had training? (Y) \_\_\_\_\_ (N) \_\_\_\_\_

Are warning signs in place? (N/A) \_\_\_\_\_ (Y) \_\_\_\_\_ (N) \_\_\_\_\_

ACBM	HA#	LOCATION	CONDITION	Type of ACBM
1. Linoleum		Office A & B	Good Condition	Assumed
2.				
3.				
4.				

Comments: This facility is being used for storage.

*Dona Thakurdas*

Signature of Inspector

*5/7 /04*

Date

*Laurie Jensen*

Signature of LEA Designee

*5-10-04*

Date



# SIX-MONTH PERIODIC SURVEILLANCE EDMONSON COUNTY SCHOOLS

BUILDING NAME: Bus Garage (999)

INSPECTOR'S NAME: James P. Klyza, Jr.

TIME: 12:02 PM

DATE: 11/5/03

Has Inspector had training? (Y) \_\_\_\_\_ (N) \_\_\_\_\_

Are warning signs in place? (N/A) \_\_\_\_\_ (Y) \_\_\_\_\_ (N) \_\_\_\_\_

ACBM	HA#	LOCATION	CONDITION	Type of ACBM
1. Linoleum		Office A & B	Good Condition	Assumed
2.				
3.				
4.				

Comments: This facility is being used for storage.

Signature of Inspector

Date

Signature of LEA Designee

Date



# SIX-MONTH PERIODIC SURVEILLANCE EDMONSON COUNTY SCHOOLS

BUILDING NAME: Bus Garage (999)

INSPECTOR'S NAME: James P. Klyza, Jr.

TIME: 11:13 AM

DATE: 4-21-03

Has Inspector had training? (Y) \_\_\_\_\_ (N) \_\_\_\_\_

Are warning signs in place? (N/A) \_\_\_\_\_ (Y) \_\_\_\_\_ (N) \_\_\_\_\_

ACBM	HA#	LOCATION	CONDITION	Type of ACBM
1. Linoleum		Office A & B	Good Condition	Assumed
2.				
3.				
4.				

Comments: This facility is being used for storage.

Signature of Inspector

Date

Signature of LEA Designee

Date



# SIX-MONTH PERIODIC SURVEILLANCE EDMONSON COUNTY SCHOOLS

BUILDING NAME: Bus Garage (999)

INSPECTOR'S NAME: Lenora M. Tietz

TIME: 10:20 AM

DATE: 11-7-02

Has Inspector had training? (Y) \_\_\_\_\_ (N) \_\_\_\_\_

Are warning signs in place? (N/A) \_\_\_\_\_ (Y) \_\_\_\_\_ (N) \_\_\_\_\_

ACBM	HA#	LOCATION	CONDITION	Type of ACBM
1. Linoleum		Office A & B	Good Condition	Assumed
2.				
3.				
4.				

Comments: This facility is being used for storage.

*Lenora M. Tietz*  
Signature of Inspector

*11-14-02*  
Date

*Samie Danah*  
Signature of LEA Designee

*11-15-02*  
Date



# SIX-MONTH PERIODIC SURVEILLANCE EDMONSON COUNTY SCHOOLS

BUILDING NAME: Bus Garage (999)

INSPECTOR'S NAME: Troy F. Wilder

TIME: 11:15 AM

DATE: 5/5/02

Has Inspector had training? (Y) \_\_\_\_\_ (N) \_\_\_\_\_

Are warning signs in place? (N/A) \_\_\_\_\_ (Y) \_\_\_\_\_ (N) \_\_\_\_\_

ACBM	HA#	LOCATION	CONDITION
1. Linoleum		Office A & B	Good Condition
2.			
3.			
4.			

Comments:

Signature of Inspector

Date

Signature of LEA Designee

Date

**Edmonson County Schools**  
**SIX MONTH PERIODIC SURVEILLANCE**

BUILDING NAME: Bus Garage (999)

INSPECTOR'S NAME: Tim Robinson

TIME: 12:45 PM

DATE: 10/15/01

Has Inspector had training? (Y) \_\_\_\_\_ (N) \_\_\_\_\_

Are warning signs in place? (N/A) \_\_\_\_\_ (Y) \_\_\_\_\_ (N) \_\_\_\_\_

ACBM	HA#	LOCATION	CONDITION
1. Linoleum		Office A & B	Good Condition
2.			
3.			
4.			

Comments:

---

---

---



Signature of Inspector

10-16-01

Date

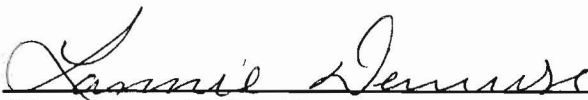

Signature of LEA Designee

Date

10-18-01



Edmonson County Schools  
**SIX MONTH PERIODIC SURVEILLANCE**

BUILDING NAME: Bus Garage (999)

INSPECTOR'S NAME: Tim Robinson

TIME: 12:35 PM

DATE: 10/31/00

Has Inspector had training? (Y) X (N) \_\_\_\_\_

Are warning signs in place? (N/A) X (Y) \_\_\_\_\_ (N) \_\_\_\_\_

ACBM	LOCATION	CONDITION
1. Linoleum	Office A & B	Good Condition
2.		
3.		
4.		

Comments:

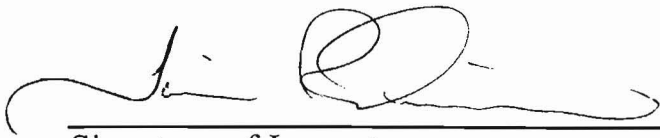

Signature of Inspector

11-1-00

Date

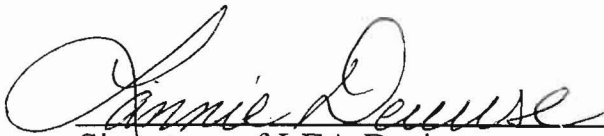

Signature of LEA Designee

11-7-00

Date

Edmonson County Schools  
**SIX MONTH PERIODIC SURVEILLANCE**

BUILDING NAME: Bus Garage (999)

INSPECTOR'S NAME: Lenora M. Nicol

TIME: 10:20 AM

DATE: 5/24/00

Has Inspector had training? (Y) X (N) \_\_\_\_\_

Are warning signs in place? (N/A) X (Y) \_\_\_\_\_ (N) \_\_\_\_\_

ACBM	LOCATION	CONDITION
1. Linoleum	Office A & B	Good Condition
2.		
3.		
4.		

Comments:

  
Signature of Inspector

6-2-00  
Date

  
Signature of LEA Designee

6-12-00  
Date

Edmonson County Schools  
**SIX MONTH PERIODIC SURVEILLANCE**

BUILDING NAME: Bus Garage (999)

INSPECTOR'S NAME: Byron A. Jones

TIME: 3:00PM

DATE: 10-18-99

Has Inspector had training? (Y) X (N) \_\_\_\_\_

Are warning signs in place? (N/A) \_\_\_\_\_ (Y) \_\_\_\_\_ (N) \_\_\_\_\_

ACBM	LOCATION	CONDITION
1. Linoleum	Office A & B	Good Condition
2.		
3.		
4.		

Comments:

---

---

---

Byron A. Jones  
Signature of Inspector

10-19-99  
Date

Lessie Damm  
Signature of LEA Designee

10-19-99  
Date

Edmonson County Schools  
**SIX MONTH PERIODIC SURVEILLANCE**

BUILDING NAME: Bus Garage (999)

INSPECTOR'S NAME: Lenora M. Nicol

TIME: 11:00AM

DATE: 4-19-99

Has Inspector had training? (Y) X (N) \_\_\_\_\_

Are warning signs in place? (N/A) \_\_\_\_\_ (Y) \_\_\_\_\_ (N) \_\_\_\_\_

ACBM	LOCATION	CONDITION
1. Linoleum	Office A & B	Good Condition
2.		
3.		
4.		

Comments:

Lenora M. Nicol  
Signature of Inspector

4-30-99  
Date

\_\_\_\_\_  
Signature of LEA Designee

\_\_\_\_\_  
Date

EDMONSON COUNTY BOARD OF EDUCATION  
P.O. BOX 129 - TELEPHONE 502-597-2101  
BROWNSVILLE, KY 42210  
502-597-2103 TELECOPIER

Earnest R. Smith, JR., Ph. D.  
Superintendent

ASBESTOS PERIODIC SURVEILLANCE

Date of Surveillance Oct. 25, 1996  
School or Building Bus Garage  
Location of ACBM (Room) Office A. 2nd Rest room  
Material Containing ACBM Laid Linoleum  
Assessment Category N.F. ASSUMED  
Condition (Changed or Unchanged) Yes

APRIL 29 1997 NO change LD  
OCT 2 1997 N/C LD.  
MAY 14 1998 3 YR REINSPECTION  
OCT 7 1998 NO change LD

EDMONSON COUNTY BOARD OF EDUCATION  
P.O. BOX 129 - TELEPHONE 502-597-2101  
BROWNSVILLE, KY 42210  
502-597-2103 TELECOPIER

Earnest R. Smith, JR., Ph. D.  
Superintendent

ASBESTOS PERIODIC SURVEILLANCE

Date of Surveillance Oct. 25, 1996  
School or Building Bus Garage  
Location of ACBM (Room) Office B  
Material Containing ACBM Inlaid backing  
Assessment Category N.F. 20% Chrys.  
Condition (Changed or Unchanged) Yes

APRIL 29 1997 NO change LD  
OCT 2 1997 N/C LD.  
MAY 14 1998 34R Re-Inspection.  
OCT 7 1998 NO change LD

ASBESTOS PERIODIC SURVEILLANCE

Date of Surveillance Dec 1989 BHC  
 School or Building Bus Garage  
 Location of ACBM (Room) Office A  
 Material Containing ACBM 1x1 ceiling tiles  
 Assessment Category Assured NF  
 Condition (Changed or Unchanged) Unchanged

April 1990 no change - Billy H. Clemens

Oct 1990 no change (BHC) + (N.D.)

April 12/1991 no change BHC

Oct 28 1991 no change BHC

April 11, 1992 no apparent change BHC

October 21, 1992 no change BHC

April 1 1993 no change BHC

October 7, 1993 no change BHC

April 14, 1994 no change BHC

Oct 11, 1994 no change BHC

April 11, 1995 no change BHC

May 17, 1995 3 yr Reinsp BHC

Oct 3, 1995 - (2) Samples taken 5/19/95 show no asbestos with previous samples this is brought to life out of asbestos surveillance

ASBESTOS PERIODIC SURVEILLANCE

Date of Surveillance Dec 1989 BNC  
 School or Building Bus Garage  
 Location of ACM (Room) Office B.D. (Back)  
 Material Containing ACM 1x1 ceiling tiles  
 Assessment Category Assured N.F.  
 Condition (Changed or Unchanged) Unchanged

April 1990 no change Billy H. Clemens  
 Oct 1990 no change BNC & NJ.  
 April 12/1991 no change BNC  
 Oct 28 1991 no change BNC  
 April 11/1992 no change BNC  
 Oct 21 1992 no change BNC  
 April 1 1993 no change BNC  
 Oct 7 1993 no change BNC  
 April 14, 1993 no change BNC  
 Oct 11, 1994 no change BNC  
 April 11, 1995 no change BNC  
 May 17, 1995 3 yr retest BNC

Oct 3, 1995 (2) samples taken 5/19/95 show no ~~asp~~ asbestos with previous samples this is enough to take out of asbestos surveillance



ASBESTOS PERIODIC SURVEILLANCE

Date of Surveillance Dec 1989 BHC  
 School or Building Bus Garage  
 Location of ACBM (Room) Office B (Back)  
 Material Containing ACBM Backing Insulation  
 Assessment Category NF 20% chrys.  
 Condition (Changed or Unchanged) unchanged

April 1990 - no change Billy H. Clemon  
 Oct 1990 no change (BHC) INJ  
 April 12/1991 no change BHC  
 Oct 28 1991 no change BHC  
 April 11 1992 no change BHC  
 Oct. 21 1992 no change BHC  
 April 1, 1993 no change BHC  
 Oct 7 1993 no change BHC  
 April 14, 1994 no change BHC  
 Oct 10, 1994 no change BHC  
 April 11, 1995 no change BHC  
 May 17, 1995 3 yr Revisit BHC  
 Oct 3, 1995 no change BHC  
 April 5, 1996 no change BHC  
 Oct 25, 1996 no chg. HIG

# ASBESTOS PERIODIC SURVEILLANCE

Date of Surveillance Dec 1989 BHe  
 School or Building Buss School  
 Location of ACBM (Room) Office A and Rest Room  
 Material Containing ACBM enclaved linoleum  
 Assessment Category Assumed NF  
 Condition (Changed or Unchanged) unchanged

April 1990 - no change Billy & Eleanor

Oct 1990 no change BHe & HJ

April 12, 1991 BHe

Oct 28 1991 no change BHe

April 11 1992 no change BHe

Oct 21 1992 no change BHe

April 1 1993 no change BHe

Oct 7 1993 no change BHe

April 14 1994 no change BHe

Oct 11, 1994 no change BHe

April 11, 1995 no change BHe

May 17, 1995 3 yr Resp BHe

Oct 3, 1995 no change BHe

April 5, 1995 no change BHe

Oct. 25, 1996 no chg. HJ

# Reinspections

# ASHERA INSPECTION REPORT-KENTUCKY

DEP4061

Rev. 10-97

LEA Edmonson County School SCHOOL Old Bus Garage (999)

Introduction. The Asbestos Hazard Emergency Response Act (AHERA) requires Local Education Agencies (LEAs) to use accredited inspectors to reinspect asbestos-containing building materials (ACBM) which were identified in the previous AHERA inspection(s). Reinspections are required at least once every three years after the management plan goes into effect for those school buildings whose last inspection/reinspection identified ACBM. Reinspection results must be submitted to the LEA and the Division for Air Quality within 30 days after the reinspection. Results must include information regarding (1) reinspected and newly discovered ACBM (amounts, assessments, sampling, information, etc.); (2) any needed revisions by accredited management planners and LEAs to response actions planned; (3) records of periodic surveillance, O&M training, O&M activities, fiber releases, and response actions taken; (4) accreditations, assurances, annual plan availability notifications to parents and employees, and other AHERA required information.

Instructions for completing this form: Complete either item I. or item II., below, as appropriate. Do not complete this form if no ACBM was identified in the last inspection/reinspection.

X I. Reinspection results show no change to information in existing management plan. (If checked, then accredited inspector needs to attach a newly completed Form 5.0 and current accreditation certificates, and LEA representatives and inspector need to sign the assurances immediately below. Also include in the submittal the information identified in items (3) and (4) above.)

I affirm that an accredited AHERA inspector has reinspected all confirmed and assumed ACBM identified in previous AHERA inspections/reinspections and, if applicable, has verified (attach verification) removal of previously identified ACBM which has been removed since the last inspection/reinspection.

Accredited Inspector's Signature/Date

*Christopher K. Allen*

5/31/13

LEA Designated Person's Signature/Date

*Debra J. Deane*

5-31-13

LEA Superintendent's Signature/Date

*John B. Wilkins*

5-31-2013

Reinspection Date 5/10/13

II. Reinspection reports show change to information in management plan. (If checked, then items identified in I., above, must be submitted, along with all revised or new homogeneous area forms, revised or new responses recommended by management planner and selected by LEA, and sampling methodology and results.)

Number of 6.0 forms attached \_\_\_\_\_ (one for each homogeneous area, or HA)

Number of 6.1 forms attached \_\_\_\_\_

Number of 3.0 forms attached \_\_\_\_\_

Number of 3.1 forms attached \_\_\_\_\_ (one for each response in each HA)

Number of samples taken \_\_\_\_\_

I affirm that an accredited AHERA inspector has reinspected all confirmed and assumed ACBM identified in previous AHERA inspections/reinspections and has verified (attach verification) removal of previously identified ACBM which has been removed since the last inspection/reinspection.

Accredited Inspector's Signature/Date

LEA Designated person's Signature/Date

Accredited Management Planner's Signature/Date

LEA Superintendent's Signature/Date

Reinspection Date \_\_\_\_\_

Effective Date of Management Plan Revisions \_\_\_\_\_

**MANAGEMENT PLANNER (MP)** (ATTACH COPY OF TRAINING COURSE CERTIFICATES IN APPENDICES)

MANAGEMENT PLANNER: Christopher K. Adkins  
ADDRESS: P.O. Box 55410, Lex, KY 40509  
PHONE NO.: (859) 299-0046

MP SIGNATURE: *Christopher K. Adkins*

KY ACCREDITATION NO.: P12-07-1569  
TRAINING AGENCY: The EI Group, Inc.  
TRAINING COURSE: AHERA Management Planner Refresher  
COURSE DATE: 6/21/12

**LOCAL EDUCATION AGENCY (LEA) DESIGNEE**

DESIGNEE NAME: Lannie Deweese  
ADDRESS: P.O. Box 129 Brownsville, Ky 42210  
PHONE NO.: 270-597-2172

TRAINING AGENCY: The Environmental Institute  
TRAINING COURSE: Inspector & Management Planner Refresher Course  
DATE(S) TAKEN: 4/2/98 HOURS IN COURSE: 8

**DOCUMENT SUMMARY**

- |   |   |
|---|---|
| <input checked="" type="checkbox"/> 1.0 COVER SHEET   | <input checked="" type="checkbox"/> 5.0 SCHOOL INFORMATION FORM<br>ONE (1) FOR EACH SCHOOL              |
| <input checked="" type="checkbox"/> 2.0 SCHOOLS   | <input checked="" type="checkbox"/> 6.0 HOMOGENEOUS AREA (HA) FORM<br>ONE (1) FOR EACH HOMOGENEOUS AREA |
| <input checked="" type="checkbox"/> 3.0 RESPONSE ACTIONS<br>MANAGEMENT PLANNER RECOMMENDATIONS<br>ONE (1) FOR EACH SCHOOL               | <input type="checkbox"/> 6.1 HOMOGENEOUS AREA DRAWING<br>ONE (1) DRAWING FOR EACH HOMOGENEOUS AREA      |
| <input checked="" type="checkbox"/> 3.1 RESPONSE ACTIONS<br>DETAILED ACTION TO BE TAKEN BY LEA<br>ONE (1) FORM FOR EACH RESPONSE ACTION | <input type="checkbox"/> BULK SAMPLE LOG/ANALYSIS   |
| <input checked="" type="checkbox"/> 4.0 FOLLOW-UP ACTIONS<br>ONE (1) FOR EACH SCHOOL  | <input type="checkbox"/> APPENDICES   |

THE SIGNATURES BELOW CERTIFY THAT THE LOCAL EDUCATION AGENCY RESPONSIBILITIES, AS STIPULATED IN USEPA 40CFR PART 763.84 HAVE BEEN MET OR WILL BE MET.

X *P. J. Waddell*  
LEA AHERA DESIGNEE SIGNATURE

5/31/13  
DATE

*Lannie Deweese*  
LEA SUPERINTENDENT SIGNATURE

5-31-13  
DATE

**COVER SHEET** AHERA MANAGEMENT PLAN - KENTUCKY SCHOOLS

AS REQUIRED UNDER  
ASBESTOS HAZARD EMERGENCY RESPONSE ACT OF 1986 (AHERA)  
US ENVIRONMENTAL PROTECTION AGENCY REGULATIONS  
(40 CFR PART 763 SUBPART E ASBESTOS-CONTAINING MATERIALS IN SCHOOLS)

LEA: Edmonson County Schools

151  
LEA NO.

ADDRESS: P.O. Box 129 Brownsville, KY 42210

SUPERINTENDENT: Patrick Waddell

PHONE: 270-597-2101

KDOE SCHOOL NO.	SCHOOL NAME OR BUILDING NAME	ADDRESS	CITY	ZIP CODE	A C B M				NO ACBM
					CONFIRMED F	NF	ASSUMED F	NF	
22	5th/6th Center (former Middle School)	191 W. Center St.	Brownsville	42210		X	X		
60	High School	220 Wildcat Way	Brownsville	42210		X	X		
50	Middle School	210 Wildcat Way	Brownsville	42210					X
80	Kyrook Elementary School	5720 Hwy. 259 N.	Sweden	42285	X	X			
20	South Edmonson Elementary	1058 Chalybeate School Rd.	Smiths Grove	42171					X
999	Central Office	100 Wildcat Way	Brownsville	42210					X
999	Bus Garage & Maintenance Office	500 Houchin Ferry Road	Brownsville	42210					X
999	Old Bus Garage (storage only)	102 Maple St.	Brownsville	42210		X			

## SCHOOLS

List All Schools & Separate Buildings

## LEGEND

F-Friable

NF-Nonfriable

ACBM-Asbestos Containing Building Material

LEA: Edmonson County Schools  
LEA Name

151  
LEA No.

5/31/13  
Management Plan Date

DEP6048

## ASSESSMENT CATEGORIES

- 1- Damaged/significantly damaged TSI
- 2- Damaged friable surfacing ACM
- 3- Significantly damaged friable surfacing ACM
- 4- Damaged or significantly damaged friable miscellaneous ACM
- 5- ACBM with potential for damage
- 6- ACBM with potential for significant damage
- 7- Any remaining friable or friable suspected ACBM

HA#	FS#	MATERIAL TYPE DESCRIPTION	T H E T R S M I A L	S U R F A C E F I N I S H I N G	QUANTITIES Lin.Ft. Sq.Ft.	S G S O M R E Y N T #	E N T M E A S	P R O G R A M	R E P A I R	P S U L A T E	E N C L O S E	R E M O V E	I S O L A T E	O T H E R	SCHEDULE		
															START DATE	COMPL DATE	
1		Linoleum			X		120	5		X						5/13	Ongoing

## RESPONSE ACTIONS

## RECOMMENDED BY MANAGEMENT PLANNER



MANAGEMENT PLANNER SIGNATURE

5/31/13

DATE

SCHOOL: Old Bus Garage (Storage Only)

SCHOOL NAME

999

SCHOOL NO.

LEA: Edmonson County Schools

LEA NAME

151

LEA NO.

5/31/13

MGT. PLAN DATE

**RESPONSE ACTION (RA)**

USE ONE SHEET FOR EACH DIFFERENT RESPONSE ACTION

☐ INSTITUTE PREVENTIVE MEASURES☐ REPAIR☐ ENCLOSE☐ ISOLATE☐ OPERATION & MAINTENANCE PROGRAM☐ ENCAPSULATE☐ REMOVE☐ OTHER

DETAILED DESCRIPTION OF MARKED RESPONSE ACTION

Standard O &amp; M procedures per 40 CFR 763.91 are to be followed in order to ensure that minimal fiber releases occur.

**LOCATIONS**

LIST ALL HOMOGENEOUS AREA NOS., FUNCTIONAL SPACE NOS., OR ATTACH DRAWING

HA # 1

**REASONS**

GIVE REASONS FOR LISTING RESPONSE ACTIONS(RA)

(IF RA IS DIFFERENT FROM RECOMMENDATIONS ON FORM 3.0 - LIST REASONS FOR CHANGE)

Necessary to prevent or address fiber release

**SCHEDULE**

STARTING DATE(S) AND COMPLETION DATE(S) FOR RESPONSE ACTION

Ongoing until funds are available to remove the ACBM.

**RESOURCES NEEDED**

(TRAINED PERSONNEL, TOOLS, COST)

O &amp; M trained personnel and equipment.

**RESPONSE ACTION**

TO BE IMPLEMENTED BY LEA

SCHOOL: Old Bus Garage  
SCHOOL NAME999  
SCHOOL NO.LEA: Edmonson County Schools151  
LEA NO.



---

**NOTIFICATION PLAN**

FOR INFORMING OCCUPANTS ABOUT ASBESTOS-RELATED ACTIVITIES AT THIS SCHOOL

The Edmonson County School will provide written notification to parent, teacher and employee organizations that the management plan is available for public inspection. Thereafter, at least once each school year, workers and building occupants, or their legal guardians will be informed about inspections, response actions, and post-response action activities, including periodic reinspection and surveillance activities that are planned or in progress.

---

**PERIODIC SURVEILLANCE PLAN**

TO BE CONDUCTED AT LEAST EVERY SIX MONTHS AFTER THE EFFECTIVE DATE OF THE MANAGEMENT PLAN

The Edmonson County School shall schedule a reassessment of ACBM in each building containing ACBM every six months by a person who will: 1) visually inspect all areas that are identified in the management plan as ACBM; 2) record the date of inspection, his or her name, and any changes in the condition of the materials; and 3) submit to the person designated to carry out general LEA responsibilities, a copy of such record for inclusion into the management plan.

---

**REINSPECTION PLAN**

TO BE CONDUCTED EVERY 3 YEARS AFTER THE EFFECTIVE DATE OF THE MANAGEMENT PLAN

The Edmonson County School shall schedule a reinspection of ACBM in each building every three years by an accredited inspector who shall submit to the person designated to carry out general LEA responsibilities a copy of the records of inspection for inclusion into the management plan.

---

**FOLLOW-UP ACTIONS****TO BE IMPLEMENTED BY LEA**

SCHOOL:	<u>Old Bus Garage</u>	<u>999</u>
	SCHOOL NAME	SCHOOL NO.
LEA:	<u>Edmonson County Schools</u>	<u>151</u>
	LEA NAME	LEA NO.

## INSPECTION INFORMATION

ATTACH A COPY OF TRAINING COURSE CERTIFICATE FOR EACH MEMBER

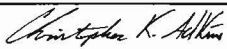
	TEAM MEMBERS (PRINT OR TYPE)	SIGNATURE	ACCREDITATION NO.	TITLE
5/10/13 SURVEY DATE(S)				
N/A (locked) SURVEY TIME(S)	Chris Adkins		P12-07-1569	Insp/Mgmt Plan

## BUILDING STATISTICS

(OPTIONAL)

DATE BUILT	AREA NAME, ADDITION, WINGS ETC.	USE	TOTAL AREA	FLOORS

## NOTES:

This building is only used for storage.

## CONSTRUCTION INFORMATION

(OPTIONAL)

WALLS:	<input type="checkbox"/> MASONRY VENEER	FLOOR STRUCTURE:	<input type="checkbox"/> WOOD	ROOF STRUCTURE:	<input type="checkbox"/> WOOD
	<input type="checkbox"/> SOLID MASONRY/CONCRETE		<input type="checkbox"/> CONCRETE		<input type="checkbox"/> CONCRETE
	<input type="checkbox"/> WOOD		<input type="checkbox"/> STEEL		<input type="checkbox"/> STEEL
	<input type="checkbox"/> OTHER		<input type="checkbox"/> OTHER		<input type="checkbox"/> OTHER
NOTES:					

## SCHOOL INFORMATION FORM

LEA:	Edmonson County School	151
SCHOOL OR BUILDING NAME:	Old Bus Garage	LEA NO.
ADDRESS:	102 Maple Street Brownsville, KY 42210	999
		SCHOOL NO.

Steven L. Beshear  
Governor



Leonard K. Peters  
Secretary

**Commonwealth of Kentucky**  
**Energy and Environment Cabinet**  
**Department for Environmental Protection**  
Division for Air Quality  
200 Fair Oaks Lane, 1<sup>st</sup> Floor  
Frankfort, Kentucky 40601-1403  
www.air.ky.gov

July 12, 2012

Mr. Christopher Adkins  
Air Source Technology, Inc.  
160 Prosperous Place, Suite 201  
Lexington, KY 40509

RE: P12-07-1569

Issued: July 12, 2012  
Expires: June 21, 2013

Dear Mr. Adkins:

This is to acknowledge receipt of your application for accreditation renewal as an asbestos abatement professional. Your application for *asbestos management planner* has been approved and the above-referenced card is enclosed.

Kentucky is issuing accreditation in five disciplines. It is important to note that accreditation in some disciplines automatically allows performance in other disciplines. A management planner is automatically allowed to perform additionally as an inspector, and an abatement supervisor is automatically allowed to perform additionally as an abatement worker. The initial accreditation fee is \$100.00 per person per discipline, except for abatement worker (\$20.00). For example, if anyone seeks accreditation as an inspector and an abatement worker, the fee will be \$120.00 and they will be issued two cards. If they seek accreditation in all five disciplines, the fee is \$300.00, and they will be issued three cards; one for project designer, management planner for inspections and plans, and supervisor for the other two disciplines. The renewal fee is one-half the initial fee. There is a \$10.00 duplication charge to replace a lost card.

If you have any questions regarding this matter you may call (502) 564-3999.

Sincerely,

*Cindy K. Mitchell*

Environmental Technologist III  
Field Support Section

COMMONWEALTH OF KENTUCKY  
DEPARTMENT FOR ENVIRONMENTAL PROTECTION  
DIVISION FOR AIR QUALITY

CONFIRMS THAT  
**CHRISTOPHER ADKINS**  
Has fulfilled the training requirements of 401 KAR 58:005 and is  
ACCREDITED as an  
**ASBESTOS MANAGEMENT PLANNER**

Date Issued 07-12-12 Expires 06-21-13

*Cindy K. Mitchell*  
Cindy Mitchell  
Environmental Technologist III

*John S. Lyons*  
John S. Lyons  
Director

No. P12-07-1569

# AHERA INSPECTION REPORT-KENTUCKY

DEP4061

Rev. 10-97

LEA Edmonson County School SCHOOL Old Bus Garage (999)

Introduction. The Asbestos Hazard Emergency Response Act (AHERA) requires Local Education Agencies (LEAs) to use accredited inspectors to reinspect asbestos-containing building materials (ACBM) which were identified in the previous AHERA inspection(s). Reinspections are required at least once every three years after the management plan goes into effect for those school buildings whose last inspection/reinspection identified ACBM.

Reinspection results must be submitted to the LEA and the Division for Air Quality within 30 days after the reinspection. Results must include information regarding (1) reinspected and newly discovered ACBM (amounts, assessments, sampling, information, etc.); (2) any needed revisions by accredited management planners and LEAs to response actions planned; (3) records of periodic surveillance, O&M training, O&M activities, fiber releases, and response actions taken; (4) accreditations, assurances, annual plan availability notifications to parents and employees, and other AHERA required information.

Instructions for completing this form: Complete either item I. or item II., below, as appropriate. Do not complete this form if no ACBM was identified in the last inspection/reinspection.

X I.

Reinspection results show no change to information in existing management plan.  
(If checked, then accredited inspector needs to attach a newly completed Form 5.0 and current accreditation certificates, and LEA representatives and inspector need to sign the assurances immediately below. Also include in the submittal the information identified in items (3) and (4) above.)

I affirm that an accredited AHERA inspector has reinspected all confirmed and assumed ACBM identified in previous AHERA inspections/reinspections and, if applicable, has verified (attach verification) removal of previously identified ACBM which has been removed since the last inspection/reinspection.

Accredited Inspector's Signature/Date

*Samuel R. Violette*

4/16/10

LEA Designated Person's Signature/Date

*Stephanie J. Dyer*

4-21-10

LEA Superintendent's Signature/Date

*Pat H. Walker*

4-21-10

Reinspection Date 3/18/10

II.

Reinspection reports show change to information in management plan.  
(If checked, then items identified in I., above, must be submitted, along with all revised or new homogeneous area forms, revised or new responses recommended by management planner and selected by LEA, and sampling methodology and results.)

Number of 6.0 forms attached \_\_\_\_\_ (one for each homogeneous area, or HA)

Number of 6.1 forms attached \_\_\_\_\_

Number of 3.0 forms attached \_\_\_\_\_

Number of 3.1 forms attached \_\_\_\_\_ (one for each response in each HA)

Number of samples taken \_\_\_\_\_

I affirm that an accredited AHERA inspector has reinspected all confirmed and assumed ACBM identified in previous AHERA inspections/reinspections and has verified (attach verification) removal of previously identified ACBM which has been removed since the last inspection/reinspection.

Accredited Inspector's Signature/Date

LEA Designated person's Signature/Date

Accredited Management Planner's Signature/Date

LEA Superintendent's Signature/Date

Reinspection Date \_\_\_\_\_

Effective Date of Management Plan Revisions \_\_\_\_\_

**MANAGEMENT PLANNER (MP)** (ATTACH COPY OF TRAINING COURSE CERTIFICATES IN APPENDICES)

MANAGEMENT PLANNER: Daniel R. Violette  
ADDRESS: 160 Prosperous Place Ste.# 201, Lexington, KY 40509  
PHONE NO.: (859) 299-0046  
MP SIGNATURE: 

KY ACCREDITATION NO.: P10-03-0351  
TRAINING AGENCY: Environmental Training Center  
TRAINING COURSE: AHERA Inspector/Management Planner  
COURSE DATE: 2/16/10

**LOCAL EDUCATION AGENCY (LEA) DESIGNEE**

DESIGNEE NAME: Lannie Deweese  
ADDRESS: P.O Box 129 Brownsville, Ky 42210  
PHONE NO.: 270-597-2172

TRAINING AGENCY: The Environmental Institute  
TRAINING COURSE: Inspector & Management Planner Refresher Course  
DATE(S) TAKEN: 4/2/98 HOURS IN COURSE: 8

**DOCUMENT SUMMARY**

- |   |   |
|---|---|
| <input checked="" type="checkbox"/> 1.0 COVER SHEET   | <input checked="" type="checkbox"/> 5.0 SCHOOL INFORMATION FORM<br>ONE (1) FOR EACH SCHOOL              |
| <input checked="" type="checkbox"/> 2.0 SCHOOLS   | <input checked="" type="checkbox"/> 6.0 HOMOGENEOUS AREA (HA) FORM<br>ONE (1) FOR EACH HOMOGENEOUS AREA |
| <input checked="" type="checkbox"/> 3.0 RESPONSE ACTIONS<br>ONE (1) FOR EACH SCHOOL               | <input type="checkbox"/> 6.1 HOMOGENEOUS AREA DRAWING<br>ONE (1) DRAWING FOR EACH HOMOGENEOUS AREA      |
| <input checked="" type="checkbox"/> 3.1 RESPONSE ACTIONS<br>ONE (1) FORM FOR EACH RESPONSE ACTION | <input type="checkbox"/> BULK SAMPLE LOG/ANALYSIS   |
| <input checked="" type="checkbox"/> 4.0 FOLLOW-UP ACTIONS<br>ONE (1) FOR EACH SCHOOL              | <input type="checkbox"/> APPENDICES   |

THE SIGNATURES BELOW CERTIFY THAT THE LOCAL EDUCATION AGENCY RESPONSIBILITIES, AS STIPULATED IN USEPA 40CFR PART 763.84 HAVE BEEN MET OR WILL BE MET.

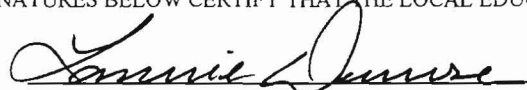
  
LEA AHERA DESIGNEE SIGNATURE

4-21-10  
DATE

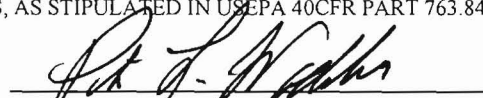
  
LEA SUPERINTENDENT SIGNATURE

4-21-10  
DATE

**COVER SHEET** AHERA MANAGEMENT PLAN - KENTUCKY SCHOOLS

AS REQUIRED UNDER  
ASBESTOS HAZARD EMERGENCY RESPONSE ACT OF 1986 (AHERA)  
US ENVIRONMENTAL PROTECTION AGENCY REGULATIONS  
(40 CFR PART 763 SUBPART E ASBESTOS-CONTAINING MATERIALS IN SCHOOLS)

LEA: Edmonson County Schools  
LEA NAME  
ADDRESS: P.O. Box 129 Brownsville, KY 42210  
SUPERINTENDENT: Patrick Waddell  
PHONE: 270-597-2101

151  
LEA NO.

4/16/10

Management Plan Date

KDOE SCHOOL NO.	SCHOOL NAME OR BUILDING NAME	ADDRESS	CITY	ZIP CODE	A C B M				NO ACBM
					CONFIRMED F	NF	ASSMUMED F	NF	
22	5th/6th Center (former Middle School)	191 W. Center St.	Brownsville	42210		X	X		
60	High School	220 Wildcat Way	Brownsville	42210		X	X		
50	Middle School	210 Wildcat Way	Brownsville	42210					X
80	Kyrook Elementary School	5720 Hwy. 259 N.	Brownsville	42210	X	X			
20	South Edmonson Elementary	1058 Chalybeate School Rd.	Brownsville	42210					X
999	Central Office	100 Wildcat Way	Brownsville	42210					X
999	Bus Garage & Maintenance Office	500 Houchin Ferry Road	Brownsville	42210					X
999	Old Bus Garage (storage only)	102 Maple St.	Brownsville	42210		X			

# SCHOOLS

List All Schools & Seperate Buildings

## LEGEND

F-Friable

NF-Nonfriable

ACBM-Asbestos Containing Building Material

LEA: Edmonson County Schools  
LEA Name

151  
LEA No.

4/16/10  
Management Plan Date

DEP6048

## ASSESSMENT CATEGORIES

- 1- Damaged/significantly damaged TSI
- 2- Damaged friable surfacing ACM
- 3- Significantly damaged friable surfacing ACM
- 4- Damaged or significantly damaged friable miscellaneous ACM
- 5- ACBM with potential for damage
- 6- ACBM with potential for significant damage
- 7- Any remaining friable or friable suspected ACBM

HA#	FS#	MATERIAL TYPE DESCRIPTION	T H E T R S M I A L	S U R F A C I N G	Q U A N T I T I E S	Lin.Ft.	Sq.Ft.	A C B M T #	I N S T R U M E N T S	O & P R E V E N T I O N S	E N C A P S U L A T I O N S	E N C O U R A G E D	R E M O V E D	I N S O L A T E D	O T H E R	S C H E D U L E	START DATE	COMPL DATE
1		Linoleum		X		120		5		X							4/10	Ongoing

## RESPONSE ACTIONS

## RECOMMENDED BY MANAGEMENT PLANNER



MANAGEMENT PLANNER SIGNATURE

4/16/10  
DATE

SCHOOL: Old Bus Garage (Storage Only)

SCHOOL NAME

999

SCHOOL NO.

LEA: Edmonson County Schools

LEA NAME

151

LEA NO.

4/16/10

MGT. PLAN DATE

**RESPONSE ACTION (RA)**

USE ONE SHEET FOR EACH DIFFERENT RESPONSE ACTION

☐ INSTITUTE PREVENTIVE MEASURES☐ REPAIR☐ ENCLOSE☐ ISOLATE☐ OPERATION & MAINTENANCE PROGRAM☐ ENCAPSULATE☐ REMOVE☐ OTHER

DETAILED DESCRIPTION OF MARKED RESPONSE ACTION

Standard O & M procedures per 40 CFR 763.91 are to be followed in order to ensure that minimal fiber releases occur.

**LOCATIONS**

LIST ALL HOMOGENEOUS AREA NOS., FUNCTIONAL SPACE NOS., OR ATTACH DRAWING

HA # 1

**REASONS**

GIVE REASONS FOR LISTING RESPONSE ACTIONS(RA)

(IF RA IS DIFFERENT FROM RECOMMENDATIONS ON FORM 3.0 - LIST REASONS FOR CHANGE)

Necessary to prevent or address fiber release

**SCHEDULE**

STARTING DATE(S) AND COMPLETION DATE(S) FOR RESPONSE ACTION

Ongoing until funds are available to remove the ACBM.

**RESOURCES NEEDED**

(TRAINED PERSONNEL, TOOLS, COST)

O & M trained personnel and equipment.

**RESPONSE ACTION**

TO BE IMPLEMENTED BY LEA

SCHOOL: Old Bus Garage  
SCHOOL NAME999  
SCHOOL NO.LEA: Edmonson County Schools151  
LEA NO.



---

**NOTIFICATION PLAN**

FOR INFORMING OCCUPANTS ABOUT ASBESTOS-RELATED ACTIVITIES AT THIS SCHOOL

The Edmonson County School will provide written notification to parent, teacher and employee organizations that the management plan is available for public inspection. Thereafter, at least once each school year, workers and building occupants, or their legal guardians will be informed about inspections, response actions, and post-response action activities, including periodic reinspection and surveillance activities that are planned or in progress.

---

**PERIODIC SURVEILLANCE PLAN**

TO BE CONDUCTED AT LEAST EVERY SIX MONTHS AFTER THE EFFECTIVE DATE OF THE MANAGEMENT PLAN

The Edmonson County School shall schedule a reassessment of ACBM in each building containing ACBM every six months by a person who will: 1) visually inspect all areas that are identified in the management plan as ACBM; 2) record the date of inspection, his or her name, and any changes in the condition of the materials; and 3) submit to the person designated to carry out general LEA responsibilities, a copy of such record for inclusion into the management plan.

---

**REINSPECTION PLAN**

TO BE CONDUCTED EVERY 3 YEARS AFTER THE EFFECTIVE DATE OF THE MANAGEMENT PLAN

The Edmonson County School shall schedule a reinspection of ACBM in each building every three years by an accredited inspector who shall submit to the person designated to carry out general LEA responsibilities a copy of the records of inspection for inclusion into the management plan.

---

**FOLLOW-UP ACTIONS****TO BE IMPLEMENTED BY LEA**SCHOOL: Old Bus Garage  
SCHOOL NAME999  
SCHOOL NO.LEA: Edmonson County School  
LEA NAME151  
LEA NO.

## INSPECTION INFORMATION

ATTACH A COPY OF TRAINING COURSE CERTIFICATE FOR EACH MEMBER

	TEAM MEMBERS (PRINT OR TYPE)	SIGNATURE	ACCREDITATION NO.	TITLE
<u>3/18/10</u> SURVEY DATE(S)	<u>Daniel R. Violette</u>	<u><i>Daniel R. Violette</i></u>	<u>P10-03-0351</u>	<u>Inspector / Management Pl</u>
<u>N/A (locked)</u> SURVEY TIME(S)				

## BUILDING STATISTICS

(OPTIONAL)

DATE BUILT	AREA NAME, ADDITION, WINGS ETC.	USE	TOTAL AREA	FLOORS

## NOTES:

This building is only used for storage.

## CONSTRUCTION INFORMATION

(OPTIONAL)

WALLS:	<input type="checkbox"/> MASONRY VENEER	FLOOR STRUCTURE:	<input type="checkbox"/> WOOD	ROOF STRUCTURE:	<input type="checkbox"/> WOOD
	<input type="checkbox"/> SOLID MASONRY/CONCRETE		<input type="checkbox"/> CONCRETE		<input type="checkbox"/> CONCRETE
	<input type="checkbox"/> WOOD		<input type="checkbox"/> STEEL		<input type="checkbox"/> STEEL
	<input type="checkbox"/> OTHER		<input type="checkbox"/> OTHER		<input type="checkbox"/> OTHER

## NOTES:

## SCHOOL INFORMATION FORM

LEA:	<u>Edmonson County School</u>	<u>151</u>
		LEA NO.
SCHOOL OR BUILDING NAME:	<u>Old Bus Garage</u>	
ADDRESS:	<u>102 Maple Street Brownsville, KY 42210</u>	<u>999</u>
		SCHOOL NO.

Steven L. Beshear  
Governor



Leonard K. Peters  
Secretary

**Commonwealth of Kentucky**  
**Energy and Environment Cabinet**  
**Department for Environmental Protection**

Division for Air Quality  
200 Fair Oaks Lane, 1<sup>st</sup> Floor  
Frankfort, Kentucky 40601-1408  
www.air.ky.gov

March 1, 2010

Mr. Daniel R. Violette  
Air Source Technology, Inc.  
160 Prosperous Pl., Ste. 201  
Lexington, KY 40509

RE: P10-03-0351

Issued: March 1, 2010  
Expires: February 16, 2011

Dear Mr. Violette:

This is to acknowledge receipt of your application for accreditation renewal as an asbestos abatement professional. Your application for *asbestos management planner* has been approved and the above-referenced card is enclosed.

Kentucky is issuing accreditation in five disciplines. It is important to note that accreditation in some disciplines automatically allows performance in other disciplines. A management planner is automatically allowed to perform additionally as an inspector, and an abatement supervisor is automatically allowed to perform additionally as an abatement worker. The initial accreditation fee is \$100.00 per person per discipline, except for abatement worker (\$20.00). For example, if anyone seeks accreditation as an inspector and an abatement worker, the fee will be \$120.00 and they will be issued two cards. If they seek accreditation in all five disciplines, the fee is \$300.00, and they will be issued three cards; one for project designer, management planner for inspections and plans, and supervisor for the other two disciplines. The renewal fee is one-half the initial fee. There is a \$10.00 duplication charge to replace a lost card.

If you have any questions regarding this matter you may call Ms. Cindy Mitchell at (502) 564-3999.

Sincerely,

A handwritten signature in black ink, appearing to read "Parker H. Moore".

Parker H. Moore, Supervisor  
Field Support Section

**COMMONWEALTH OF KENTUCKY**  
**DEPARTMENT FOR ENVIRONMENTAL PROTECTION**  
**DIVISION FOR AIR QUALITY**

CONFIRMS THAT

**DANIEL R. VIOLETTE**

Has fulfilled the training requirements of 401 KAR 58:005 and is  
ACCREDITED as an

**ASBESTOS MANAGEMENT PLANNER**

Date Issued 03-01-10 Expires 02-16-11

A handwritten signature in black ink, appearing to read "Parker H. Moore".

Parker H. Moore  
Branch Manager

A handwritten signature in black ink, appearing to read "John S. Lyons".

John S. Lyons  
Director

No. P10-03-0351

**AHERA INSPECTION REPORT-KENTUCKY**

DEP4061  
Rev. 10-97

LEA Edmonson County School SCHOOL Old Bus Garage (999)

**Introduction.** The Asbestos Hazard Emergency Response Act (AHERA) requires Local Education Agencies (LEAs) to use accredited inspectors to reinspect asbestos-containing building materials (ACBM) which were identified in the previous AHERA inspection(s). Reinspections are required at least once every three years after the management plan goes into effect for those school buildings whose last inspection/reinspection identified ACBM.

Reinspection results must be submitted to the LEA and the Division for Air Quality within 30 days after the reinspection. Results must include information regarding (1) reinspected and newly discovered ACBM (amounts, assessments, sampling, information, etc.); (2) any needed revisions by accredited management planners and LEAs to response actions planned; (3) records of periodic surveillance, O&M training, O&M activities, fiber releases, and response actions taken; (4) accreditations, assurances, annual plan availability notifications to parents and employees, and other AHERA required information.

**Instructions for completing this form: Complete either item I. or item II., below, as appropriate. Do not complete this form if no ACBM was identified in the last inspection/reinspection.**

  X   I. Reinspection results show no change to information in existing management plan.  
(If checked, then accredited inspector needs to attach a newly completed Form 5.0 and current accreditation certificates, and LEA representatives and inspector need to sign the assurances immediately below. Also include in the submittal the information identified in items (3) and (4) above.)

I affirm that an accredited AHERA inspector has reinspected all confirmed and assumed ACBM identified in previous AHERA inspections/reinspections and, if applicable, has verified (attach verification) removal of previously identified ACBM which has been removed since the last inspection/reinspection.

Accredited Inspector's Signature/Date

*Samuel R. Violette*

3/26/07

LEA Designated Person's Signature/Date

*Samuel R. Violette*

4-11-07

LEA Superintendent's Signature/Date

*John L. Nicholson*

4-12-07

Reinspection Date 3/15/07

       II. Reinspection reports show change to information in management plan.  
(If checked, then items identified in I., above, must be submitted, along with all revised or new homogeneous area forms, revised or new responses recommended by management planner and selected by LEA, and sampling methodology and results.)

Number of 6.0 forms attached \_\_\_\_\_ (one for each homogeneous area, or HA)

Number of 6.1 forms attached \_\_\_\_\_

Number of 3.0 forms attached \_\_\_\_\_

Number of 3.1 forms attached \_\_\_\_\_ (one for each response in each HA)

Number of samples taken \_\_\_\_\_

I affirm that an accredited AHERA inspector has reinspected all confirmed and assumed ACBM identified in previous AHERA inspections/reinspections and has verified (attach verification) removal of previously identified ACBM which has been removed since the last inspection/reinspection.

Accredited Inspector's Signature/Date

LEA Designated person's Signature/Date

Accredited Management Planner's Signature/Date

LEA Superintendent's Signature/Date

Reinspection Date \_\_\_\_\_

Effective Date of Management Plan Revisions \_\_\_\_\_

MANAGEMENT PLANNER (MP) (ATTACH COPY OF TRAINING COURSE CERTIFICATES IN APPENDICES)

MANAGEMENT PLANNER: Daniel R. Violette  
ADDRESS: 160 Prosperous Place Ste.# 201, Lexington, KY 40509  
PHONE NO.: (859) 299-0046  
MP SIGNATURE: 

KY ACCREDITATION NO.: P07-01-0182  
TRAINING AGENCY: Environmental Specialties  
TRAINING COURSE: AHERA Inspector/Management Planner  
COURSE DATE: 1/19/07

LOCAL EDUCATION AGENCY (LEA) DESIGNEE

DESIGNEE NAME: Lannie Deweese  
ADDRESS: P.O Box 129 Brownsville, Ky 42210  
PHONE NO.: 270-597-2172

TRAINING AGENCY: The Environmental Institute  
TRAINING COURSE: Inspector & Management Planner Refresher Course  
DATE(S) TAKEN: 4/2/98 HOURS IN COURSE: 8

DOCUMENT SUMMARY

- |  |   |
|--|---|
| <input checked="" type="checkbox"/> 1.0 COVER SHEET                              | <input checked="" type="checkbox"/> 5.0 SCHOOL INFORMATION FORM |
|  | ONE (1) FOR EACH SCHOOL   |
| <input checked="" type="checkbox"/> 2.0 SCHOOLS                                  | <input type="checkbox"/> 6.0 HOMOGENEOUS AREA (HA) FORM         |
|  | ONE (1) FOR EACH HOMOGENEOUS AREA                               |
| <input type="checkbox"/> 3.0 RESPONSE ACTIONS MANAGEMENT PLANNER RECOMMENDATIONS | <input type="checkbox"/> 6.1 HOMOGENEOUS AREA DRAWING           |
| ONE (1) FOR EACH SCHOOL  | ONE (1) DRAWING FOR EACH HOMOGENEOUS AREA                       |
| <input type="checkbox"/> 3.1 RESPONSE ACTIONS DETAILED ACTION TO BE TAKEN BY LEA | <input type="checkbox"/> BULK SAMPLE LOG/ANALYSIS               |
| ONE (1) FORM FOR EACH RESPONSE ACTION  |   |
| <input checked="" type="checkbox"/> 4.0 FOLLOW-UP ACTIONS                        | <input type="checkbox"/> APPENDICES                             |
| ONE (1) FOR EACH SCHOOL  |   |

THE SIGNATURES BELOW CERTIFY THAT THE LOCAL EDUCATION AGENCY RESPONSIBILITIES, AS STIPULATED IN USEPA 40CFR PART 763.84 HAVE BEEN MET OR WILL BE MET.

  
LEA AHERA DESIGNEE SIGNATURE

4-11-07  
DATE

  
LEA SUPERINTENDENT SIGNATURE

4-17-07  
DATE

COVER SHEET AHERA MANAGEMENT PLAN - KENTUCKY SCHOOLS

AS REQUIRED UNDER  
ASBESTOS HAZARD EMERGENCY RESPONSE ACT OF 1986 (AHERA)  
US ENVIRONMENTAL PROTECTION AGENCY REGULATIONS  
(40 CFR PART 763 SUBPART E ASBESTOS-CONTAINING MATERIALS IN SCHOOLS)

LEA: Edmonson County Schools  
LEA NAME  
ADDRESS: P.O. Box 129 Brownsville, KY 42210  
SUPERINTENDENT: Patrick Waddell  
PHONE: 270-597-2101

151  
LEA NO.

KDOE SCHOOL NO.	SCHOOL NAME OR BUILDING NAME	ADDRESS	CITY	ZIP CODE	A C B M				NO ACBM
					CONFIRMED F	CONFIRMED NF	ASSUMED F	ASSUMED NF	
060	Edmonson County High School	220 Wildcat Way	Brownsville	42210		X	X		
050	Edmonson County 5&6/Middle School	191 W. Center Street	Brownsville	42210		X	X		
021	Edmonson County Preschool	181 S. Main Street	Brownsville	42210	X	X	X		
	Center ( Old Brownsville Elem.)								
080	Kyrock Elementary	5720 Highway 259 N.	Sweden	42285	X	X			
020	South Edmonson Elementary	1058 Chalybeate School Road	Smiths Grove	42171					X
999	Old Bus Garage	102 Maple Street	Brownsville	42210		X			
999	New Bus Garage	500 Houchin Ferry Road	Brownsville	42210					X

# SCHOOLS

List All Schools & Seperate Buildings

## LEGEND

F-Friable

NF-Nonfriable

ACBM-Asbestos Containing Building Material

LEA: Edmonson County Schools  
LEA Name

151  
LEA No.

10/12/88  
Management Plan Date

---

**NOTIFICATION PLAN****FOR INFORMING OCCUPANTS ABOUT ASBESTOS-RELATED ACTIVITIES AT THIS SCHOOL**

The Edmonson County School will provide written notification to parent, teacher and employee organizations that the management plan is available for public inspection. Thereafter, at least once each school year, workers and building occupants, or their legal guardians will be informed about inspections, response actions, and post-response action activities, including periodic reinspection and surveillance activities that are planned or in progress.

---

**PERIODIC SURVEILLANCE PLAN****TO BE CONDUCTED AT LEAST EVERY SIX MONTHS AFTER THE EFFECTIVE DATE OF THE MANAGEMENT PLAN**

The Edmonson County School shall schedule a reassessment of ACBM in each building containing ACBM every six months by a person who will: 1) visually inspect all areas that are identified in the management plan as ACBM; 2) record the date of inspection, his or her name, and any changes in the condition of the materials; and 3) submit to the person designated to carry out general LEA responsibilities, a copy of such record for inclusion into the management plan.

---

**REINSPECTION PLAN****TO BE CONDUCTED EVERY 3 YEARS AFTER THE EFFECTIVE DATE OF THE MANAGEMENT PLAN**

The Edmonson County School shall schedule a reinspection of ACBM in each building every three years by an accredited inspector who shall submit to the person designated to carry out general LEA responsibilities a copy of the records of inspection for inclusion into the management plan.

---

**FOLLOW-UP ACTIONS  
TO BE IMPLEMENTED BY LEA**

SCHOOL:	<u>Old Bus Garage</u>	<u>999</u>
	SCHOOL NAME	SCHOOL NO.
LEA:	<u>Edmonson County School</u>	<u>151</u>
	LEA NAME	LEA NO.

## INSPECTION INFORMATION

ATTACH A COPY OF TRAINING COURSE CERTIFICATE FOR EACH MEMBER

	TEAM MEMBERS (PRINT OR TYPE)	SIGNATURE	ACCREDITATION NO.	TITLE
<u>3/15/07</u> SURVEY DATE(S)	<u>Daniel R. Violette</u>	<u><i>Daniel R. Violette</i></u>	<u>P07-01-0182</u>	<u>Inspector / Management Plz</u>
<u>2:00PM</u> SURVEY TIME(S)				

## BUILDING STATISTICS

(OPTIONAL)

DATE BUILT	AREA NAME, ADDITION, WINGS ETC.	USE	TOTAL AREA	FLOORS

NOTES:

## CONSTRUCTION INFORMATION

(OPTIONAL)

WALLS:	<input type="checkbox"/> MASONRY VENEER	FLOOR STRUCTURE:	<input type="checkbox"/> WOOD	ROOF STRUCTURE:	<input type="checkbox"/> WOOD
	<input type="checkbox"/> SOLID MASONRY/CONCRETE		<input type="checkbox"/> CONCRETE		<input type="checkbox"/> CONCRETE
	<input type="checkbox"/> WOOD		<input type="checkbox"/> STEEL		<input type="checkbox"/> STEEL
	<input type="checkbox"/> OTHER		<input type="checkbox"/> OTHER		<input type="checkbox"/> OTHER
NOTES:					

## SCHOOL INFORMATION FORM

LEA:	<u>Edmonson County School</u>	<u>151</u> LEA NO.
SCHOOL OR BUILDING NAME:	<u>Old Bus Garage</u>	
ADDRESS:	<u>102 Maple Street Brownsville, KY 42210</u>	<u>999</u> SCHOOL NO.



# AHERA INSPECTION REPORT-KENTUCKY

DEP4061

Rev. 10-97

LEA Edmonson County School SCHOOL Old Bus Garage (999)

**Introduction.** The Asbestos Hazard Emergency Response Act (AHERA) requires Local Education Agencies (LEAs) to use accredited inspectors to reinspect asbestos-containing building materials (ACBM) which were identified in the previous AHERA inspection(s). Reinspections are required at least once every three years after the management plan goes into effect for those school buildings whose last inspection/reinspection identified ACBM.

Reinspection results must be submitted to the LEA and the Division for Air Quality within 30 days after the reinspection. Results must include information regarding (1) reinspected and newly discovered ACBM (amounts, assessments, sampling, information, etc.); (2) any needed revisions by accredited management planners and LEAs to response actions planned; (3) records of periodic surveillance, O&M training, O&M activities, fiber releases, and response actions taken; (4) accreditations, assurances, annual plan availability notifications to parents and employees, and other AHERA required information.

**Instructions for completing this form: Complete either item I. or item II., below, as appropriate. Do not complete this form if no ACBM was identified in the last inspection/reinspection.**

X I.

Reinspection results show no change to information in existing management plan.

*(If checked, then accredited inspector needs to attach a newly completed Form 5.0 and current accreditation certificates, and LEA representatives and inspector need to sign the assurances immediately below. Also include in the submittal the information identified in items (3) and (4) above.)*

I affirm that an accredited AHERA inspector has reinspected all confirmed and assumed ACBM identified in previous AHERA inspections/reinspections and, if applicable, has verified (*attach verification*) removal of previously identified ACBM which has been removed since the last inspection/reinspection.

Accredited Inspector's Signature/Date

Donna Thakurdas

5/6/04

LEA Designated Person's Signature/Date

LEA Superintendent's Signature/Date

Reinspection Date 4/22/04

       II.

Reinspection reports show change to information in management plan.

*(If checked, then items identified in I., above, must be submitted, along with all revised or new homogeneous area forms, revised or new responses recommended by management planner and selected by LEA, and sampling methodology and results.)*

Number of 6.0 forms attached        (one for each homogeneous area, or HA)

Number of 6.1 forms attached       

Number of 3.0 forms attached       

Number of 3.1 forms attached        (one for each response in each HA)

Number of samples taken       

I affirm that an accredited AHERA inspector has reinspected all confirmed and assumed ACBM identified in previous AHERA inspections/reinspections and has verified (*attach verification*) removal of previously identified ACBM which has been removed since the last inspection/reinspection.

Accredited Inspector's Signature/Date

LEA Designated person's Signature/Date

Accredited Management Planner's Signature/Date

LEA Superintendent's Signature/Date

Reinspection Date       

Effective Date of Management Plan Revisions

**MANAGEMENT PLANNER (MP)** (ATTACH COPY OF TRAINING COURSE CERTIFICATES IN APPENDICES)

MANAGEMENT PLANNER: M. Dona Thakurdas  
ADDRESS: 160 Prosperous Place Ste.# 201  
PHONE NO.: (859) 299-0046  
MP SIGNATURE: Dona Thakurdas

KY ACCREDITATION NO.: P04-03-0367  
TRAINING AGENCY: The Environmental Training Center  
TRAINING COURSE: AHERA Inspector/Management Planner  
COURSE DATE: 2/16/04 - 2/20/04

**LOCAL EDUCATION AGENCY (LEA) DESIGNEE**

DESIGNEE NAME: Lannie Deweese  
ADDRESS: P.O Box 129 Brownsville, Ky 42210  
PHONE NO.: 270-597-2172

TRAINING AGENCY: The Environmental Institute  
TRAINING COURSE: Inspector & Management Planner Refresher Course  
DATE(S) TAKEN: 4/2/98 HOURS IN COURSE: 8

**DOCUMENT SUMMARY**

- |   |  |
|---|--|
| <input checked="" type="checkbox"/> 1.0 COVER SHEET   | <input checked="" type="checkbox"/> 5.0 SCHOOL INFORMATION FORM<br>ONE (1) FOR EACH SCHOOL         |
| <input checked="" type="checkbox"/> 2.0 SCHOOLS   | <input type="checkbox"/> 6.0 HOMOGENEOUS AREA (HA) FORM<br>ONE (1) FOR EACH HOMOGENEOUS AREA       |
| <input type="checkbox"/> 3.0 RESPONSE ACTIONS MANAGEMENT PLANNER RECOMMENDATIONS<br>ONE (1) FOR EACH SCHOOL               | <input type="checkbox"/> 6.1 HOMOGENEOUS AREA DRAWING<br>ONE (1) DRAWING FOR EACH HOMOGENEOUS AREA |
| <input type="checkbox"/> 3.1 RESPONSE ACTIONS DETAILED ACTION TO BE TAKEN BY LEA<br>ONE (1) FORM FOR EACH RESPONSE ACTION | <input type="checkbox"/> BULK SAMPLE LOG/ANALYSIS  |
| <input checked="" type="checkbox"/> 4.0 FOLLOW-UP ACTIONS<br>ONE (1) FOR EACH SCHOOL                                      | <input type="checkbox"/> APPENDICES  |

THE SIGNATURES BELOW CERTIFY THAT THE LOCAL EDUCATION AGENCY RESPONSIBILITIES, AS STIPULATED IN USEPA 40CFR PART 763.84 HAVE BEEN MET OR WILL BE MET.

\_\_\_\_\_  
LEA AHERA DESIGNEE SIGNATURE

\_\_\_\_\_  
DATE

\_\_\_\_\_  
LEA SUPERINTENDENT SIGNATURE

\_\_\_\_\_  
DATE

**COVER SHEET** AHERA MANAGEMENT PLAN - KENTUCKY SCHOOLS

AS REQUIRED UNDER  
ASBESTOS HAZARD EMERGENCY RESPONSE ACT OF 1986 (AHERA)  
US ENVIRONMENTAL PROTECTION AGENCY REGULATIONS  
(40 CFR PART 763 SUBPART E ASBESTOS-CONTAINING MATERIALS IN SCHOOLS)

LEA: Edmonson County Schools

LEA NAME

151

LEA NO.

ADDRESS: P.O. Box 129 Brownsville, KY 42210

SUPERINTENDENT: Darrell Cassady

PHONE: 270-597-2101

10/12/88

Management Plan Date

KDOE SCHOOL NO.	SCHOOL NAME OR BUILDING NAME	ADDRESS	CITY	ZIP CODE	A C B M				NO ACBM
					CONFIRMED F	NF	ASSUMED F	NF	
060	Edmonson County High School	220 Wildcat Way	Brownsville	42210	X				
050	Edmonson County Middle School	191 W. Center Street	Brownsville	42210		X	X		
021	Edmonson County Preschool	181 S. Main Street	Brownsville	42210	X	X	X		
	Center ( Old Brownsville Elem.)								
080	Kyrock Elementary	5720 Highway 259 N.	Sweden	42285	X	X			
020	South Edmonson Elementary	1058 Chalybeate School Road	Smiths Grove	42171					X
999	Old Bus Garage	102 Maple Street	Brownsville	42210		X			
999	New Bus Garage	500 Houchin Ferry Road	Brownsville	42210					X

# SCHOOLS

List All Schools & Separate Buildings

## LEGEND

F-Friable

NF-Nonfriable

ACBM-Asbestos Containing Building Material

LEA: Edmonson County Schools  
LEA Name

151  
LEA No.

10/12/88  
Management Plan Date

---

**NOTIFICATION PLAN**

FOR INFORMING OCCUPANTS ABOUT ASBESTOS-RELATED ACTIVITIES AT THIS SCHOOL

The Edmonson County School will provide written notification to parent, teacher and employee organizations that the management plan is available for public inspection. Thereafter, at least once each school year, workers and building occupants, or their legal guardians will be informed about inspections, response actions, and post-response action activities, including periodic reinspection and surveillance activities that are planned or in progress.

---

**PERIODIC SURVEILLANCE PLAN**

TO BE CONDUCTED AT LEAST EVERY SIX MONTHS AFTER THE EFFECTIVE DATE OF THE MANAGEMENT PLAN

The Edmonson County School shall schedule a reassessment of ACBM in each building containing ACBM every six months by a person who will: 1) visually inspect all areas that are identified in the management plan as ACBM; 2) record the date of inspection, his or her name, and any changes in the condition of the materials; and 3) submit to the person designated to carry out general LEA responsibilities, a copy of such record for inclusion into the management plan.

---

**REINSPECTION PLAN**

TO BE CONDUCTED EVERY 3 YEARS AFTER THE EFFECTIVE DATE OF THE MANAGEMENT PLAN

The Edmonson County School shall schedule a reinspection of ACBM in each building every three years by an accredited inspector who shall submit to the person designated to carry out general LEA responsibilities a copy of the records of inspection for inclusion into the management plan.

---

**FOLLOW-UP ACTIONS****TO BE IMPLEMENTED BY LEA**SCHOOL: Old Bus Garage  
SCHOOL NAME999  
SCHOOL NO.LEA: Edmonson County School  
LEA NAME151  
LEA NO.

## INSPECTION INFORMATION

ATTACH A COPY OF TRAINING COURSE CERTIFICATE FOR EACH MEMBER

	TEAM MEMBERS (PRINT OR TYPE)	SIGNATURE	ACCREDITATION NO.	TITLE
<u>4/22/04</u> SURVEY DATE(S)	<u>M. Dona Thakurdas</u>	<u><i>Dona Thakurdas</i></u>	<u>P04-03-0367</u>	<u>Inspector / Management Plannc</u>
<u>2:00PM</u> SURVEY TIME(S)				

## BUILDING STATISTICS

(OPTIONAL)

DATE BUILT	AREA NAME, ADDITION, WINGS ETC.	USE	TOTAL AREA	FLOORS

NOTES:

## CONSTRUCTION INFORMATION

(OPTIONAL)

WALLS: ☐ MASONRY VENEER  
☐ SOLID MASONRY/CONCRETE  
☐ WOOD  
☐ OTHER

FLOOR STRUCTURE: ☐ WOOD  
☐ CONCRETE  
☐ STEEL  
☐ OTHER

ROOF STRUCTURE: ☐ WOOD  
☐ CONCRETE  
☐ STEEL  
☐ OTHER

NOTES: \_\_\_\_\_

\_\_\_\_\_

\_\_\_\_\_

## SCHOOL INFORMATION FORM

LEA: Edmonson County School151  
LEA NO.SCHOOL OR BUILDING NAME: Old Bus GarageADDRESS: 102 Maple Street Brownsville, KY 42210999  
SCHOOL NO.

# AHERA INSPECTION REPORT-KENTUCKY

DEP4061  
 Rev. 10-97

LEA Edmonson County Schools

SCHOOL Bus Garage (999)

**Introduction.** The Asbestos Hazard Emergency Response Act (AHERA) requires Local Education Agencies (LEAs) to use accredited inspectors to reinspect asbestos-containing building materials (ACBM) which were identified in the previous AHERA inspection(s). Reinspections are required at least once every three years after the management plan goes into effect for those school buildings whose last inspection/reinspection identified ACBM. Reinspection results must be submitted to the LEA and the Division for Air Quality within 30 days after the reinspection. Results must include information regarding (1) reinspected and newly discovered ACBM (amounts, assessments, sampling, information, etc.); (2) any needed revisions by accredited management planners and LEAs to response actions planned; (3) records of periodic surveillance, O&M training, O&M activities, fiber releases, and response actions taken; (4) accreditations, assurances, annual plan availability notifications to parents and employees, and other AHERA required information.

**Instructions for completing this form: Complete either item I. or item II., below, as appropriate. Do not complete this form if no ACBM was identified in the last inspection/reinspection.**

X I. Reinspection results show no change to information in existing management plan.  
*(If checked, then accredited inspector needs to attach a newly completed Form 5.0 and current accreditation certificates, and LEA representatives and inspector need to sign the assurances immediately below. Also include in the submittal the information identified in items (3) and (4) above.)*

I affirm that an accredited AHERA inspector has reinspected all confirmed and assumed ACBM identified in previous AHERA inspections/reinspections and, if applicable, has verified (attach verification) removal of previously identified ACBM which has been removed since the last inspection/reinspection.

Accredited Inspector's Signature/Date

LEA Designated Person's Signature/Date

LEA Superintendent's Signature/Date

Reinspection Date 4/17/01

*Lenora M. Neal 4-30-01*  
*Danniel Denny 5-5-01*  
*Danniel Denny 5/4/01*

II. Reinspection reports show change to information in management plan.  
*(If checked, then items identified in I., above, must be submitted, along with all revised or new homogeneous area forms, revised or new responses recommended by management planner and selected by LEA, and sampling methodology and results.)*

Number of 6.0 forms attached \_\_\_\_\_ (one for each homogeneous area, or HA)

Number of 6.1 forms attached \_\_\_\_\_

Number of 3.0 forms attached \_\_\_\_\_

Number of 3.1 forms attached \_\_\_\_\_ (one for each response in each HA)

Number of samples taken \_\_\_\_\_

I affirm that an accredited AHERA inspector has reinspected all confirmed and assumed ACBM identified in previous AHERA inspections/reinspections and has verified (attach verification) removal of previously identified ACBM which has been removed since the last inspection/reinspection.

Accredited Inspector's Signature/Date

LEA Designated person's Signature/Date

Accredited Management Planner's Signature/Date

LEA Superintendent's Signature/Date

Reinspection Date

Effective Date of Management Plan Revisions

---

**NOTIFICATION PLAN****FOR INFORMING OCCUPANTS ABOUT ASBESTOS-RELATED ACTIVITIES AT THIS SCHOOL**

The Edmonson County Schools will provide written notification to parent, teacher and employee organizations that the management plan is available for public inspection. Thereafter, at least once each school year, workers and building occupants, or their legal guardians will be informed about inspections, response actions, and post-response action activities, including periodic reinspection and surveillance activities that are planned or in progress.

---

**PERIODIC SURVEILLANCE PLAN****TO BE CONDUCTED AT LEAST EVERY SIX MONTHS AFTER THE EFFECTIVE DATE OF THE MANAGEMENT PLAN**

The Edmonson County Schools shall schedule a reassessment of ACBM in each building containing ACBM every six months by a person who will: 1) visually inspect all areas that are identified in the management plan as ACBM; 2) record the date of inspection, his or her name, and any changes in the condition of the materials; and 3) submit to the person designated to carry out general LEA responsibilities, a copy of such record for inclusion into the management plan.

---

**REINSPECTION PLAN****TO BE CONDUCTED EVERY 3 YEARS AFTER THE EFFECTIVE DATE OF THE MANAGEMENT PLAN**

The Edmonson County Schools shall schedule a reinspection of ACBM in each building every three years by an accredited inspector who shall submit to the person designated to carry out general LEA responsibilities a copy of the records of inspection for inclusion into the management plan.

---

**FOLLOW-UP ACTIONS****TO BE IMPLEMENTED BY LEA**SCHOOL: Bus Garage  
SCHOOL NAME999  
SCHOOL NO.LEA: Edmonson County Schools  
LEA NAME151  
LEA NO.

## INSPECTION INFORMATION

ATTACH A COPY OF TRAINING COURSE CERTIFICATE FOR EACH MEMBER

4/17/01  
SURVEY DATE(S)

TEAM MEMBERS (PRINT OR TYPE)

Lenora M. Nicol

SIGNATURE

*Lenora M. Nicol*

ACCREDITATION NO.

P00-05-0878

TITLE

Insp/Mgmt Planner

9:45 AM  
SURVEY TIME(S)

## BUILDING STATISTICS

(OPTIONAL)

DATE BUILT

AREA NAME, ADDITION, WINGS ETC.

USE

TOTAL AREA

FLOORS

NOTES:

## CONSTRUCTION INFORMATION

(OPTIONAL)

WALLS:

☐ MASONRY VENEER☐ SOLID MASONRY/CONCRETE☐ WOOD☐ OTHER

FLOOR STRUCTURE:

☐ WOOD☐ CONCRETE☐ STEEL☐ OTHER

ROOF STRUCTURE:

☐ WOOD☐ CONCRETE☐ STEEL☐ OTHER

NOTES:

## SCHOOL INFORMATION FORM

LEA: Edmonson County Schools

151

SCHOOL OR BUILDING NAME: Bus Garage

LEA NO.

ADDRESS: 102 Maple. , Brownsville, Ky 42210

999  
SCHOOL NO.



JAMES E. BICKFORD  
SECRETARY



PAUL E. PATTON  
GOVERNOR

COMMONWEALTH OF KENTUCKY  
**NATURAL RESOURCES AND ENVIRONMENTAL PROTECTION CABINET**  
DEPARTMENT FOR ENVIRONMENTAL PROTECTION

DIVISION FOR AIR QUALITY  
803 SCHENKEL LN  
FRANKFORT KY 40601-1403

May 19, 2000

Ms. Lenora M. Nicol  
Air Source Technology, Inc.  
2311 Fortune Dr., Ste. 101  
Lexington, KY 40509-4118

RE: P00-05-0878

Issued: May 19, 2000  
Expires: May 15, 2001

Dear Ms. Nicol:

This is to acknowledge receipt of your application for accreditation renewal as an asbestos abatement professional. Your application for *asbestos management planner* has been approved and the above-referenced card is enclosed.

Kentucky is issuing accreditation in five disciplines. It is important to note that accreditation in some disciplines automatically allows performance in other disciplines. A management planner is automatically allowed to perform additionally as an inspector, and a contractor/supervisor is automatically allowed to perform additionally as an abatement worker. The initial accreditation fee is \$100.00 per person per discipline, except for abatement worker (\$20.00). For example, if anyone seeks accreditation as an inspector and an abatement worker, the fee will be \$120.00, and they will be issued two cards. If they seek accreditation in all five disciplines, the fee is \$300.00, and they will be issued three cards; one for project designer, management planner for inspections and plans, and supervisor for the other two disciplines. The renewal fee is one-half the initial fee. There is a \$10.00 duplication charge to replace a lost card.

If you have any questions regarding this matter, you may call Mr. Henry Lyon, of my staff, at (502) 573-3382.

COMMONWEALTH OF KENTUCKY  
DEPARTMENT FOR ENVIRONMENTAL PROTECTION  
DIVISION FOR AIR QUALITY  
CONFIRMS THAT

Lenora M. Nicol

Has fulfilled the training requirements of 401 KAR 58:005 and is  
ACCREDITED as an

**ASBESTOS MANAGEMENT PLANNER**

Date Issued 05-19-00

Expires 05-15-01

Robert W. Logan  
Commissioner

John E. Hornback  
Director

No. P00-05-0878

Sincerely,

Parker H. Moore, Manager  
Special Programs Branch

[encies/nrepc/dep/daq/daqhome.html](http://encies/nrepc/dep/daq/daqhome.html)

**PAYS**



Printed on Recycled Paper  
An Equal Opportunity Employer M/F/D

## INSPECTION INFORMATION

ATTACH A COPY OF TRAINING COURSE CERTIFICATE FOR EACH MEMBER

	TEAM MEMBERS (PRINT OR TYPE)	SIGNATURE	ACCREDITATION NO.	TITLE
4/17/01 SURVEY DATE(S)	Lenora M. Nicol	<i>Lenora M. Nicol</i>	R98-05-0407	Insp/Mgmt Planner
SURVEY TIME(S)				

## BUILDING STATISTICS

(OPTIONAL)

DATE BUILT	AREA NAME, ADDITION, WINGS ETC.	USE	TOTAL AREA	FLOORS
2000		Elementary School		

## NOTES:

This building was newly constructed and opened for the 2000-2001 school year. A letter from the architect is enclosed.

## CONSTRUCTION INFORMATION

(OPTIONAL)

WALLS:	<input type="checkbox"/> MASONRY VENEER	FLOOR STRUCTURE:	<input type="checkbox"/> WOOD	ROOF STRUCTURE:	<input type="checkbox"/> WOOD
	<input type="checkbox"/> SOLID MASONRY/CONCRETE		<input type="checkbox"/> CONCRETE		<input type="checkbox"/> CONCRETE
	<input type="checkbox"/> WOOD		<input type="checkbox"/> STEEL		<input type="checkbox"/> STEEL
	<input type="checkbox"/> OTHER		<input type="checkbox"/> OTHER		<input type="checkbox"/> OTHER

## NOTES:

## SCHOOL INFORMATION FORM

LEA:	Edmonson County Schools	151 LEA NO.
SCHOOL OR BUILDING NAME:	South Edmonson Elementary	020 SCHOOL NO.
ADDRESS:	1050 Chalybeate School Road, KY 42171	

JAMES E. BICKFORD  
SECRETARY



PAUL E. PATTON  
GOVERNOR

COMMONWEALTH OF KENTUCKY  
**NATURAL RESOURCES AND ENVIRONMENTAL PROTECTION CABINET**  
DEPARTMENT FOR ENVIRONMENTAL PROTECTION

DIVISION FOR AIR QUALITY  
803 SCHENKEL LN  
FRANKFORT KY 40601-1403

May 19, 2000

Ms. Lenora M. Nicol  
Air Source Technology, Inc.  
2311 Fortune Dr., Ste. 101  
Lexington, KY 40509-4118

RE: P00-05-0878

Issued: May 19, 2000  
Expires: May 15, 2001

Dear Ms. Nicol:

This is to acknowledge receipt of your application for accreditation renewal as an asbestos abatement professional. Your application for *asbestos management planner* has been approved and the above-referenced card is enclosed.

Kentucky is issuing accreditation in five disciplines. It is important to note that accreditation in some disciplines automatically allows performance in other disciplines. A management planner is automatically allowed to perform additionally as an inspector, and a contractor/supervisor is automatically allowed to perform additionally as an abatement worker. The initial accreditation fee is \$100.00 per person per discipline, except for abatement worker (\$20.00). For example, if anyone seeks accreditation as an inspector and an abatement worker, the fee will be \$120.00, and they will be issued two cards. If they seek accreditation in all five disciplines, the fee is \$300.00, and they will be issued three cards; one for project designer, management planner for inspections and plans, and supervisor for the other two disciplines. The renewal fee is one-half the initial fee. There is a \$10.00 duplication charge to replace a lost card.

If you have any questions regarding this matter, you may call Mr. Henry Lyon, of my staff, at (502) 573-3382.

COMMONWEALTH OF KENTUCKY  
DEPARTMENT FOR ENVIRONMENTAL PROTECTION  
DIVISION FOR AIR QUALITY  
CONFIRMS THAT

**Lenora M. Nicol**

Has fulfilled the training requirements of 401 KAR 58:005 and is  
ACCREDITED as an

**ASBESTOS MANAGEMENT PLANNER**

Date Issued **05-19-00**

Expires **05-15-01**

Robert W. Logan  
Commissioner

John E. Hornback  
Director

No. **P00-05-0878**

Sincerely,

Parker H. Moore, Manager  
Special Programs Branch

[encies/nrepc/dep/daq/daqhome.html](http://encies/nrepc/dep/daq/daqhome.html)

**PAYS**



Printed on Recycled Paper  
An Equal Opportunity Employer M/F/D

# ASHERA INSPECTION REPORT-KENTUCKY

DEP4061

Rev. 10-97

LEA Edmonson County Schools

SCHOOL Bus Garage (999)

**Introduction.** The Asbestos Hazard Emergency Response Act (AHERA) requires Local Education Agencies (LEAs) to use accredited inspectors to reinspect asbestos-containing building materials (ACBM) which were identified in the previous AHERA inspection(s). Reinspections are required at least once every three years after the management plan goes into effect for those school buildings whose last inspection/reinspection identified ACBM.

Reinspection results must be submitted to the LEA and the Division for Air Quality within 30 days after the reinspection. Results must include information regarding (1) reinspected and newly discovered ACBM (amounts, assessments, sampling, information, etc.); (2) any needed revisions by accredited management planners and LEAs to response actions planned; (3) records of periodic surveillance, O&M training, O&M activities, fiber releases, and response actions taken; (4) accreditations, assurances, annual plan availability notifications to parents and employees, and other AHERA required information.

**Instructions for completing this form: Complete either Item I. or Item II., below, as appropriate. Do not complete this form if no ACBM was identified in the last inspection/reinspection.**

X I.

Reinspection results show no change to information in existing management plan. (If checked, then accredited inspector needs to attach a newly completed Form 5.0 and current accreditation certificates, and LEA representatives and inspector need to sign the assurances immediately below. Also include in the submittal the information identified in Items (3) and (4) above.)

I affirm that an accredited AHERA inspector has reinspected all confirmed and assumed ACBM identified in previous AHERA inspections/reinspections and, if applicable, has verified (attach verification) removal of previously identified ACBM which has been removed since the last inspection/reinspection.

Accredited Inspector's Signature/Date

Lenora Neal 6/11/98

LEA Designated Person's Signature/Date

James Canale

LEA Superintendent's Signature/Date

James Canale 6/18/98

Reinspection Date 5/14/98

II.

Reinspection reports show change to information in management plan. (If checked, then items identified in I., above, must be submitted, along with all revised or new homogeneous area forms, revised or new responses recommended by management planner and selected by LEA, and sampling methodology and results.)

Number of 6.0 forms attached \_\_\_\_\_ (one for each homogeneous area, or HA)

Number of 6.1 forms attached \_\_\_\_\_

Number of 3.0 forms attached \_\_\_\_\_

Number of 3.1 forms attached \_\_\_\_\_ (one for each response in each HA)

Number of samples taken \_\_\_\_\_

I affirm that an accredited AHERA inspector has reinspected all confirmed and assumed ACBM identified in previous AHERA inspections/reinspections and has verified (attach verification) removal of previously identified ACBM which has been removed since the last inspection/reinspection.

Accredited Inspector's Signature/Date

\_\_\_\_\_

LEA Designated person's Signature/Date

\_\_\_\_\_

Accredited Management Planner's Signature/Date

\_\_\_\_\_

LEA Superintendent's Signature/Date

\_\_\_\_\_

Reinspection Date \_\_\_\_\_

Effective Date of Management Plan Revisions \_\_\_\_\_

## INSPECTION INFORMATION

ATTACH A COPY OF TRAINING COURSE CERTIFICATE FOR EACH MEMBER

5/14/98  
SURVEY DATE(S)8:20 AM  
SURVEY TIME(S)

TEAM MEMBERS (PRINT OR TYPE)

Lengra M. Nicol

SIGNATURE

*Lengra M. Nicol*

ACCREDITATION NO.

P98-05-0407

TITLE

Insp/Mgmt Planner

## BUILDING STATISTICS

(OPTIONAL)

DATE BUILT

AREA NAME, ADDITION, WINGS ETC.

USE

TOTAL AREA

FLOORS

NOTES:

## CONSTRUCTION INFORMATION

(OPTIONAL)

WALLS: ☐ MASONRY VENEER☐ SOLID MASONRY/CONCRETE☐ WOOD☐ OTHERFLOOR STRUCTURE: ☐ WOOD☐ CONCRETE☐ STEEL☐ OTHERROOF STRUCTURE: ☐ WOOD☐ CONCRETE☐ STEEL☐ OTHER

NOTES:

## SCHOOL INFORMATION FORM

LEA: Edmonson County Schools

151  
LEA NO.

SCHOOL OR BUILDING NAME: Bus Garage

ADDRESS: 102 Maple, , Brownsville, Ky 42210

999  
SCHOOL NO.

COMMONWEALTH OF KENTUCKY  
DEPARTMENT FOR ENVIRONMENTAL PROTECTION  
DIVISION FOR AIR QUALITY

CONFIRMS THAT

LENORA M. NICOL

*Has fulfilled the training requirements of 401 KAR 58:005 and is*  
ACCREDITED as an

ASBESTOS MANAGEMENT PLANNER

Date issued 05-18-98

Expires 05-08-99

Robert W. Logan  
Commissioner

John E. Hornback  
Director

No. P98-05-0407

# The TES Group

Occupational Safety & Health Instructors & Consultants

Division of Orr Safety Corporation  
13029 Middletown Industrial Boulevard  
Louisville, Kentucky 40223-4757  
(502) 244-8844

Certifies that

**Lenora Nicol**  
**398-86-6360**

Has met the requirements, including successful completion of an examination  
for the purpose of accreditation under TSCA title II, for the course titled:

**AHERA Management Planner**

Conducted at Louisville, Kentucky on May 7-8, 1998

1657

Certificate Number

4/8/98

Examination Date

4/8/99

Expires



Course Director

**Brooke A. Beyerle, CSP**



Course Director

**Cordell D. Brackett, CET**



## AHERA REINSPECTION REPORT - KENTUCKY

LEA Edmonson Co Schools SCHOOL Bus Garage

Introduction. The Asbestos Hazard Emergency Response Act (AHERA) requires Local Education Agencies (LEAs) to use accredited inspectors to reinspect asbestos-containing building materials (ACBM) which were identified in previous AHERA inspection(s). Reinspections are required at least once every three years after the management plan goes into effect for those school buildings whose last inspection/reinspection identified ACBM. For most schools, this means reinspections must be done by July 9, 1992, and the results submitted to the LEA and the Division for Air Quality within 30 days after the reinspection. Results would include information regarding (1) reinspected and newly discovered ACBM (amounts, assessments, sampling information, etc.); (2) any needed revisions by accredited management planners and LEAs to response actions planned; (3) records of periodic surveillance, O&M training, O&M activities, fiber releases, and response actions taken; and (4) accreditations, assurances, annual plan-availability notifications to parents and employees, and other AHERA-required information.

Instructions for completing this form: Complete either item I. or item II., below, as appropriate. Do not complete this form if no ACBM was identified in the last inspection/reinspection.

I. Reinspection results show no change to information in existing management plan.

(If checked, then accredited inspector needs to attach a newly completed Form 5.0 and current accreditation certificates, and LEA representatives and inspector need to sign the assurances immediately below. Also include in the submittal the information identified in items (3) and (4), above.)

I affirm that an accredited AHERA inspector has reinspected all confirmed and assumed ACBM identified in previous AHERA inspections/reinspections and, if applicable, has verified (attach verification) removal of previously identified ACBM which was removed since the last inspection/reinspection.

Accredited Inspector's Signature/Date \_\_\_\_\_

LEA Designated Person's Signature/Date \_\_\_\_\_

LEA Superintendent's Signature/Date \_\_\_\_\_

Reinspection Date \_\_\_\_\_

☒ II. Reinspection reports show change to information in management plan.

(If checked, then the items identified in I., above, must be submitted, along with all revised or new homogeneous area forms, revised or new responses recommended by management planner and selected by LEA, and sampling methodology and results.)

Number of 6.0 Forms attached 2 (one for each homogeneous area, or HA)

Number of 6.1 Forms attached 2

Number of 3.0 Forms attached 1

Number of 3.1 Forms attached \_\_\_\_\_ (one for each response in each HA)

Number of samples taken 4

I affirm that an accredited AHERA inspector has reinspected all confirmed and assumed ACBM identified in previous AHERA inspections/reinspections and has verified (attach verification) removal of previously identified ACBM which was removed since the last inspection/reinspection.

Accredited Inspector's Signature/Date Billy H. Clemmons 5/17/95

LEA Designated Person's Signature/Date Billy H. Clemmons 6/7/95

Accredited Management Planner's Signature/Date Billy H. Clemmons 6/7/95

LEA Superintendent's Signature/Date James R. Smith 6-8-95

Reinspection Date 5/17/95 Effective Date of Management Plan Revisions 6-9-95



# BUILDING STATISTICS (OPTIONAL)

DATE BUILT	AREA NAME, ADDITION, WING, ETC.	USE	TOTAL AREA	FLOORS

NOTES: \_\_\_\_\_

# CONSTRUCTION INFORMATION (OPTIONAL)

WALLS: ☐ Masonry Veneer ☐ Solid Masonry / Conc. ☐ Wood ☐ Other

FLOOR STRUCTURE: ☐ Wood ☐ Concrete ☐ Steel ☐ Other

ROOF STRUCTURE: ☐ Wood ☐ Concrete ☐ Steel ☐ Other

NOTES: \_\_\_\_\_

# DOCUMENT SUMMARY (OPTIONAL)

- |   |  |  |  |
|---|--|--|--|
| <input type="checkbox"/> Floor Plans      | <input type="checkbox"/> Specifications    | <input type="checkbox"/> Past Surveys              | <input type="checkbox"/> Past Abatement Specifications |
| <input type="checkbox"/> Sections         | <input type="checkbox"/> Mech. Drawings    | <input type="checkbox"/> In-House Sampling Reports | <input type="checkbox"/> Past Abatement Drawings       |
| <input type="checkbox"/> Finish Schedules | <input type="checkbox"/> As Built Drawings | <input type="checkbox"/> Past Abatement Projects   |  |

# INSPECTION INFORMATION

ATTACH COPY OF TRAINING COURSE CERTIFICATE FOR EACH MEMBER

SURVEY DATE (S) <u>5/17/95</u>	TEAM MEMBERS (PRINT OR TYPE) <u>Billy H. Clemmons</u>	SIGNATURE <u>Billy H. Clemmons</u>	ACCREDITATION NO. <u>D95-05-0347</u>	TITLE <u>Management Planner</u>
SURVEY TIME (S)				

# SCHOOL INFORMATION FORM

LEA: Edmonson Co. Schools LEA NO. 151

(OR BUILDING NAME) SCHOOL: Bus Garage SCHOOL NAME 299

ADDRESS: Brownsville Ky 42210 SCHOOL NO. \_\_\_\_\_



## EXPOSURE CONSIDERATIONS - OPTIONAL (Rated 1 as Best &amp; 5 as Worst)

- A. DETERIORATION  
 B. PHYSICAL DAMAGE  
 C. WATER DAMAGE  
 D. ACTIVITY/VIBRATION  
 E. EXPOSURE  
 F. ACCESSIBILITY
- G. LENGTH OF EXPOSURE  
 1. 1 HOUR/WEEK  
 2. 5 HRS/WK  
 3. 10 HRS/WK  
 4. 20 HRS/WK  
 5. 40 HRS/WK
- H. EXPOSURE POPULATION (Personnel)  
 1. MAINTENANCE ONLY  
 2. MAINT., CUSTODIAN  
 3. MAINT., CUST., FACULTY  
 4. MAINT., CUST., FAC., STUDENTS  
 5. MAINT., CUSTD., FAC., STDS., PUBLIC

## ASSESSMENT CATEGORIES

- 1 - Damaged/significantly damaged TSI  
 2 - Damaged friable SURFACING ACM  
 3 - Significantly damaged friable SURFACING ACM  
 4 - Damaged or significantly damaged friable MISCELLANEOUS ACM  
 5 - ACBM with potential for damage  
 6 - ACBM with potential for significant damage  
 7 - Any remaining friable ACBM or friable suspected ACBM

SAMPLE NO.	BIA #	EXIST RM.#	INSPECTION AREA NAME	ASBESTOS TYPE / %	EXPOSURE CONSIDERATIONS								ASSMT. CAT.	QUANTITIES			TOTALS	
					A	B	C	D	E	F	G	H		LENGTH	WD.	DIA.	LF	SF
35382		B	Office (B+RR)	0%										24	17			408
35383		RR	Office (B+RR)	0%														
2674		B	Office (B+RR)	0%														

AREAS INCLUDED IN HOMOGENEOUS AREA

MISCELLANEOUS QUANTITY CALCULATIONS

GRAND TOTAL

408

SQ.FT.

LIN.FT.

ACBM

CONFIRMED

ASSUMED

NO ACBM

F  
NFF  
NF☒

SAMPLING DATE: 5-17-95 INSPECTION DATE: 5-17-95

INSPECTOR: Billy H. Clemmons

SIGNATURE: Billy H. Clemmons

LEA: Edmonson Co. LEA NAME

SCHOOL: Bus Garage SCHOOL NAME

151 LEA NO.

999 SCHOOL NO.

MATERIAL DESCRIPTION / ADDITIONAL REASONS FOR ASSESSMENT

White Dotted 1X1 Ceiling Tile

## HOMOGENEOUS AREA FORM

## LEGEND

BIA# BUILDING INSPECTION AREA NUMBER  
 INSPECTOR ASSIGNED NO. FOR CONTROL

THERMAL(TSI) ☐SURFACING ☐MISC. ☒

MAT.TYPE:

1X1 Ceiling Tile

**EXPOSURE CONSIDERATIONS - OPTIONAL (Rated 1 as Best & 5 as Worst)**

- |                       |                       |  |
|-----------------------|-----------------------|--|
| A. DETERIORATION      | G. LENGTH OF EXPOSURE | H. EXPOSURE POPULATION (Personnel)     |
| B. PHYSICAL DAMAGE    | 1. 1 HOUR/WEEK        | 1. MAINTENANCE ONLY                    |
| C. WATER DAMAGE       | 2. 5 HRS/WK           | 2. MAINT., CUSTODIAN                   |
| D. ACTIVITY/VIBRATION | 3. 10 HRS/WK          | 3. MAINT., CUST., FACULTY              |
| E. EXPOSURE           | 4. 20 HRS/WK          | 4. MAINT., CUST., FAC., STUDENTS       |
| F. ACCESSIBILITY      | 5. 40 HRS/WK          | 5. MAINT., CUSTD., FAC., STDS., PUBLIC |

**ASSESSMENT CATEGORIES**

- 1 - Damaged/significantly damaged TSI
- 2 - Damaged friable SURFACING ACM
- 3 - Significantly damaged friable SURFACING ACM
- 4 - Damaged or significantly damaged friable MISCELLANEOUS ACM
- 5 - ACBM with potential for damage
- 6 - ACBM with potential for significant damage
- 7 - Any remaining friable ACBM or friable suspected ACBM

SAMPLE NO.	BIA #	EXIST RM.#	INSPECTION AREA NAME	ASBESTOS TYPE / %	EXPOSURE CONSIDERATIONS								ASSMT. CAT.	QUANTITIES			TOTALS	
					A	B	C	D	E	F	G	H		LENGTH	WD.	DIA.	LF	SF
35380		A	Office(A)	0%										18	17			306
35475		A	Office(A)	0%														
2589		A	Office A	0%														

AREAS INCLUDED IN HOMOGENEOUS AREA

MISCELLANEOUS QUANTITY CALCULATIONS

GRAND TOTAL

306  
SQ.FT.

LIN.FT.

ACBM

CONFIRMED

F  
NF

ASSUMED

F  
NF

NO ACBM

☒

SAMPLING DATE: 5-17-95 INSPECTION DATE: 5-17-95

INSPECTOR: Billy H. Clemmons

SIGNATURE: Billy H. Clemmons

LEA: Edmonson Co. Schools 151  
LEA NO.

SCHOOL: Bus Garage 999  
SCHOOL NO.

MATERIAL DESCRIPTION / ADDITIONAL REASONS FOR ASSESSMENT

White Smooth 1x1 Ceiling tile**HOMOGENEOUS AREA FORM****LEGEND**

BIA# BUILDING INSPECTION AREA NUMBER  
INSPECTOR ASSIGNED NO. FOR CONTROL

THERMAL(TSI) ☐SURFACING ☐MISC. ☒MAT.TYPE: 1x1 Ceiling tileBG 151-999 HA2

DRAWING NO.

HA: 3

GENEP

ASSIGNED

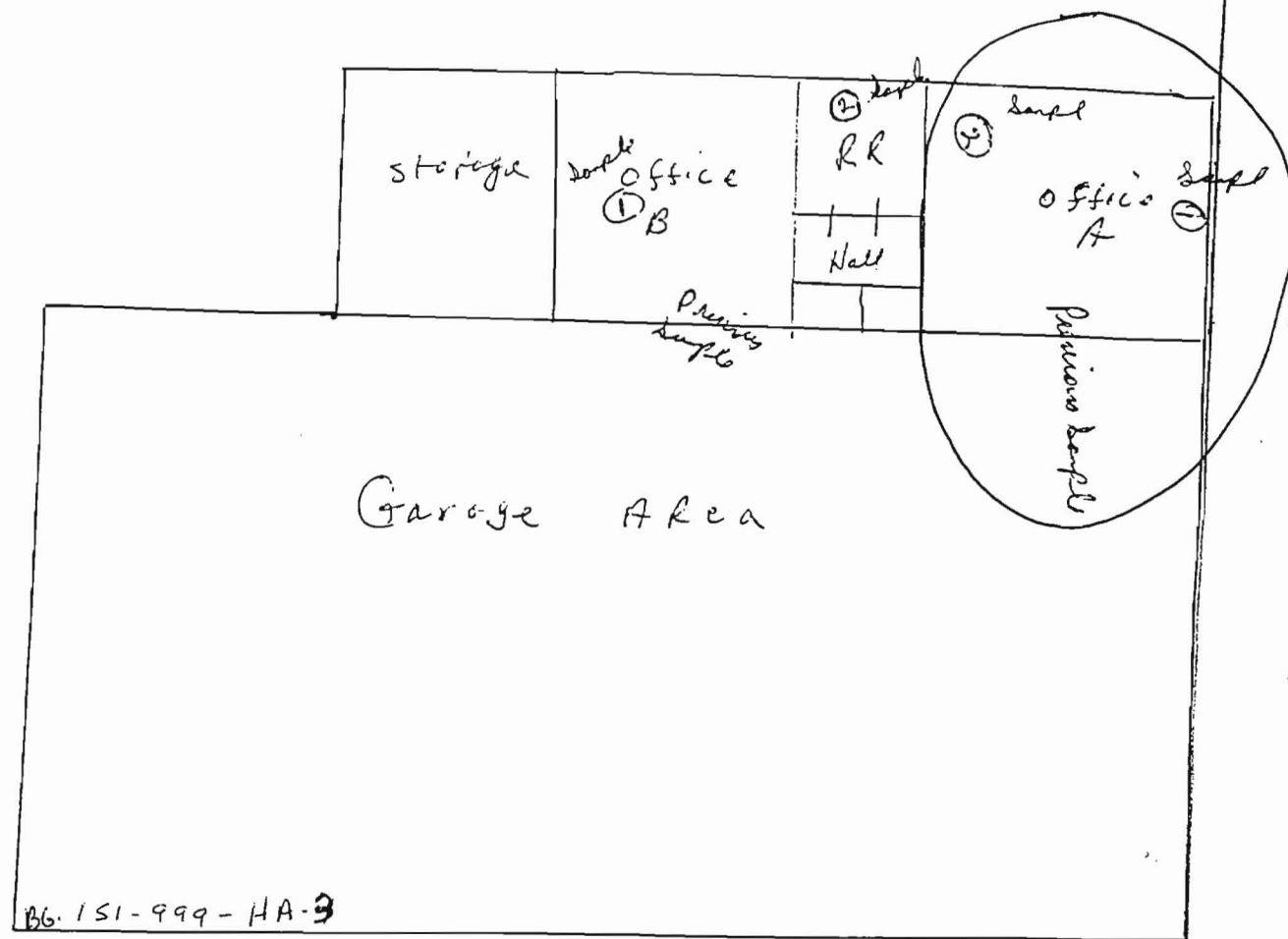

# DRAWINGS

EACH HOMOGENEOUS AREA

SCHOOL: Bass Garage  
SCHOOL NAME  
LEA: Edmonson Co. Schools  
LEA NAME

999  
SCHOOL NO.  
151  
LEA NO.

THERMAL(TSI) ☐ SURFACING ☐ MISC. ☒

MAT. TYPE: 1 x 1 Ceiling Tile

HA: 3 B6. 151-999-HA-3  
GENERIC ASSIGNED DRAWING NUMBER

MANAGEMENT PLAN DATE: 10-17-88

Office A

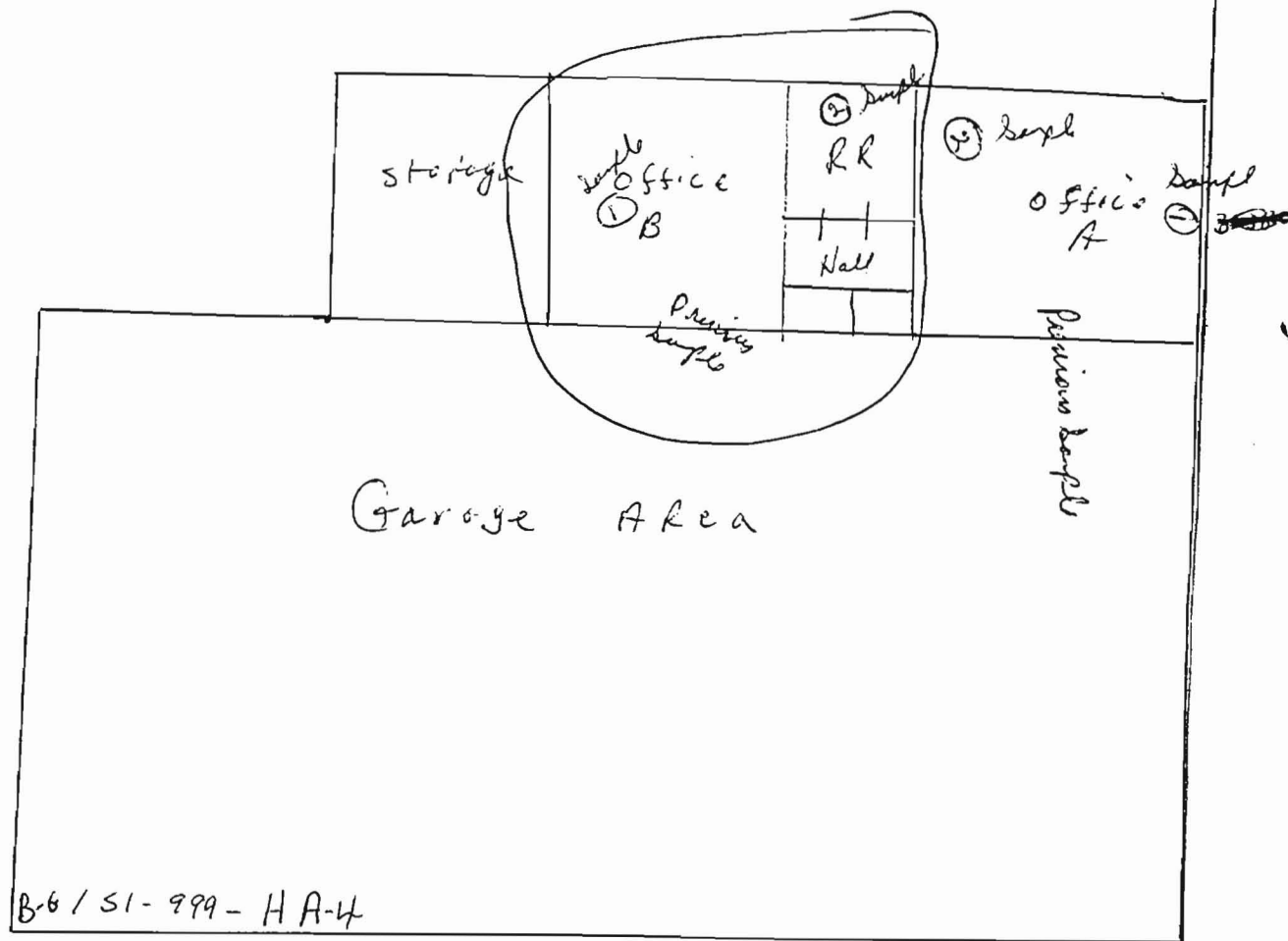

# DRAWINGS

EACH HOMOGENEOUS AREA

SCHOOL: Bus Garage  
SCHOOL NAME  
LEA: Edmerson Co. Schools  
LEA NAME

999  
SCHOOL NO.  
151  
LEA NO.

THERMAL(TSI) ☐ SURFACING ☐ MISC. ☒

MAT.TYPE: 1 x 1 Ceiling Tile

HA: 4 BC 151-999-HA4  
GENERIC ASSIGNED DRAWING NUMBER

MANAGEMENT PLAN DATE: 10-12/86

Office B & RR.



# NATIONAL LABORATORIES, INC.

Rivercity One  
3210 Claremont Ave.  
Evansville, IN 47712-4968  
Ph.: (812) 464-9000  
Fax: (812) 465-5746

NIST NVLAP #1658

NIOSH PAT #47712-001

## ANALYSIS REPORT

Sample Type: Bulk  
Set #: 3603  
Lab ID: 35383  
Client ID: 2 HA-4  
Other ID: Bus George RR -  
Ceiling Tile  
Date Received: 05-22-95  
Date Analyzed: 05-24-95

Edmonson Co. Board of Education  
P.O. Box 129  
Brownsville, KY 42210

National Laboratories, A Division of Consolidated Recycling Co., Inc., is accredited by the National Institute of Standards and Technology, National Voluntary Laboratory Accreditation Program, Lab ID #1658, for selected test method "40 CFR Chapter I (7-1-92 edition) Part 763, Subpart F, Appendix A", pages 546-551.

Sample Description: Tan/gold fibrous material with adhering paint

### ASBESTOS MINERALS

### ESTIMATED PERCENT

None Detected

### NON ASBESTOS COMPONENTS

### ESTIMATED PERCENT

Cellulose  
Paint

99%  
1%

**NOTE:** Sample percentage can vary due to analyst subjectivity.

**Remarks:** This test report relates only to the items tested and cannot be used for product endorsement by NVLAP or any agency of the U.S. Government. This sample will be disposed of by National Laboratories unless otherwise notified by client within ninety (90) days.

National Laboratories accepts full technical responsibility for this test report. Any questions concerning this report should be directed to Mr. David M. Cressler, P.E. This report must not be reproduced except in full.

Analyst

*Sharon Hunt*

**A DIVISION OF CONSOLIDATED RECYCLING CO., INC.**

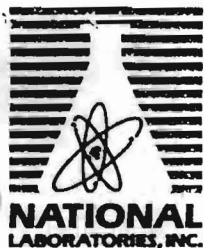

# NATIONAL LABORATORIES, INC.

NIST NVLAP #1658

NIOSH PAT #47712-001

Rivercity One  
3210 Claremont Ave.  
Evansville, IN 47712-4968  
Ph.: (812) 464-9000  
Fax: (812) 465-5746

## ANALYSIS REPORT

Sample Type: Bulk  
Set #: 3603  
Lab ID: 35382  
Client ID: 1 HA-4  
Other ID: Bus George Office B -  
Ceiling Tile  
Date Received: 05-22-95  
Date Analyzed: 05-24-95

Edmonson Co. Board of Education  
P.O. Box 129  
Brownsville, KY 42210

National Laboratories, A Division of Consolidated Recycling Co., Inc., is accredited by the National Institute of Standards and Technology, National Voluntary Laboratory Accreditation Program, Lab ID #1658, for selected test method "40 CFR Chapter I (7-1-92 edition) Part 763, Subpart F, Appendix A", pages 546-551.

Sample Description: Tan/gold fibrous material with adhering paint

### ASBESTOS MINERALS

### ESTIMATED PERCENT

None Detected

### NON ASBESTOS COMPONENTS

### ESTIMATED PERCENT

Cellulose

99%

Paint

1%

**NOTE:** Sample percentage can vary due to analyst subjectivity.

**Remarks:** This test report relates only to the items tested and cannot be used for product endorsement by NVLAP or any agency of the U.S. Government. This sample will be disposed of by National Laboratories unless otherwise notified by client within ninety (90) days.

National Laboratories accepts full technical responsibility for this test report. Any questions concerning this report should be directed to Mr. David M. Cressler, P.E. This report must not be reproduced except in full.

Analyst

*Sharon Hunt*

**A DIVISION OF CONSOLIDATED RECYCLING CO., INC.**





# NATIONAL LABORATORIES, INC.

Rivercity One  
3210 Claremont Ave.  
Evansville, IN 47712-4968  
Ph.: (812) 464-9000  
Fax: (812) 465-5746

NIST NVLAP #1658

NIOSH PAT #47712-001

## ANALYSIS REPORT

Sample Type: Bulk  
Set #: 3603  
Lab ID: 35380  
Client ID: 1-HA3  
Other ID: Bus George Office A -  
Ceiling Tile  
Date Received: 05-22-95  
Date Analyzed: 05-24-95

Edmonson Co. Board of Education  
P.O. Box 129  
Brownsville, KY 42210

National Laboratories, A Division of Consolidated Recycling Co., Inc., is accredited by the National Institute of Standards and Technology, National Voluntary Laboratory Accreditation Program, Lab ID #1658, for selected test method 40 CFR Chapter I (7-1-92 edition) Part 763, Subpart F, Appendix A, pages 546-551.

Sample Description: Brown fibrous material with adhering paint

### ASBESTOS MINERALS

### ESTIMATED PERCENT

None Detected

### NON ASBESTOS COMPONENTS

### ESTIMATED PERCENT

Cellulose

97%

Paint

3%

**NOTE:** Sample percentage can vary due to analyst subjectivity.

**Remarks:** This test report relates only to the items tested and cannot be used for product endorsement by NVLAP or any agency of the U.S. Government. This sample will be disposed of by National Laboratories unless otherwise notified by client within ninety (90) days.

National Laboratories accepts full technical responsibility for this test report. Any questions concerning this report should be directed to Mr. David M. Cressler, P.E. This report must not be reproduced except in full.

Analyst

*Sharon Hunt*

**A DIVISION OF CONSOLIDATED RECYCLING CO., INC.**

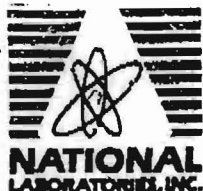

# NATIONAL LABORATORIES, INC.

NIST NVLAP #1658

NIOSH PAT #47712-001

Riverview Office  
3210 Clarentont Ave.  
Evansville, IN 47712-4968  
Ph.: (812) 434-9000  
Fax: (812) 435-5746

## ANALYSIS REPORT

Sample Type: Bulk  
Set #: 3613  
Lab ID: 35475  
Other ID: Bus Garage - Ceiling Tile  
Office A  
Date Received: 05-31-95  
Date Analyzed: 06-01-95

Edmonson County Board of Educ.  
P.O. Box 129  
Brownsville, KY 42210

National Laboratories, A Division of Consolidated Recycling Co., Inc., is accredited by the National Institute of Standards and Technology, National Voluntary Laboratory Accreditation Program, Lab ID #1658, for selected test method "40 CFR Chapter I (7-1-92 edition) Part 763, Subpart F, Appendix A", pages 548-551.

Sample Description: Brown fibrous material with adhering paint

### ASBESTOS MINERALS

### ESTIMATED PERCENT

None Detected

### NON ASBESTOS COMPONENTS

### ESTIMATED PERCENT

Cellulose  
Paint

95%  
5%

**NOTE:** Sample percentage can vary due to analyst subjectivity.

**Remarks:** This test report relates only to the items tested and cannot be used for product endorsement by NVLAP or any agency of the U.S. Government. This sample will be disposed of by National Laboratories unless otherwise notified by client within ninety (90) days.

National Laboratories accepts full technical responsibility for this test report. Any questions concerning this report should be directed to Mr. David M. Cressler, P.E. This report must not be reproduced except in full.

Analyst

*Sheron Vint*

**A DIVISION OF CONSOLIDATED RECYCLING CO., INC.**

# Edmonson Co. Bus Garage

104 Maple Street Brownsville, Ky.

Unit 5

Unit 4

(2) Samples Taken 5/19/95 of Ceiling Tile

(2) " " " " " " "

Office B + RR + Hall

Office A

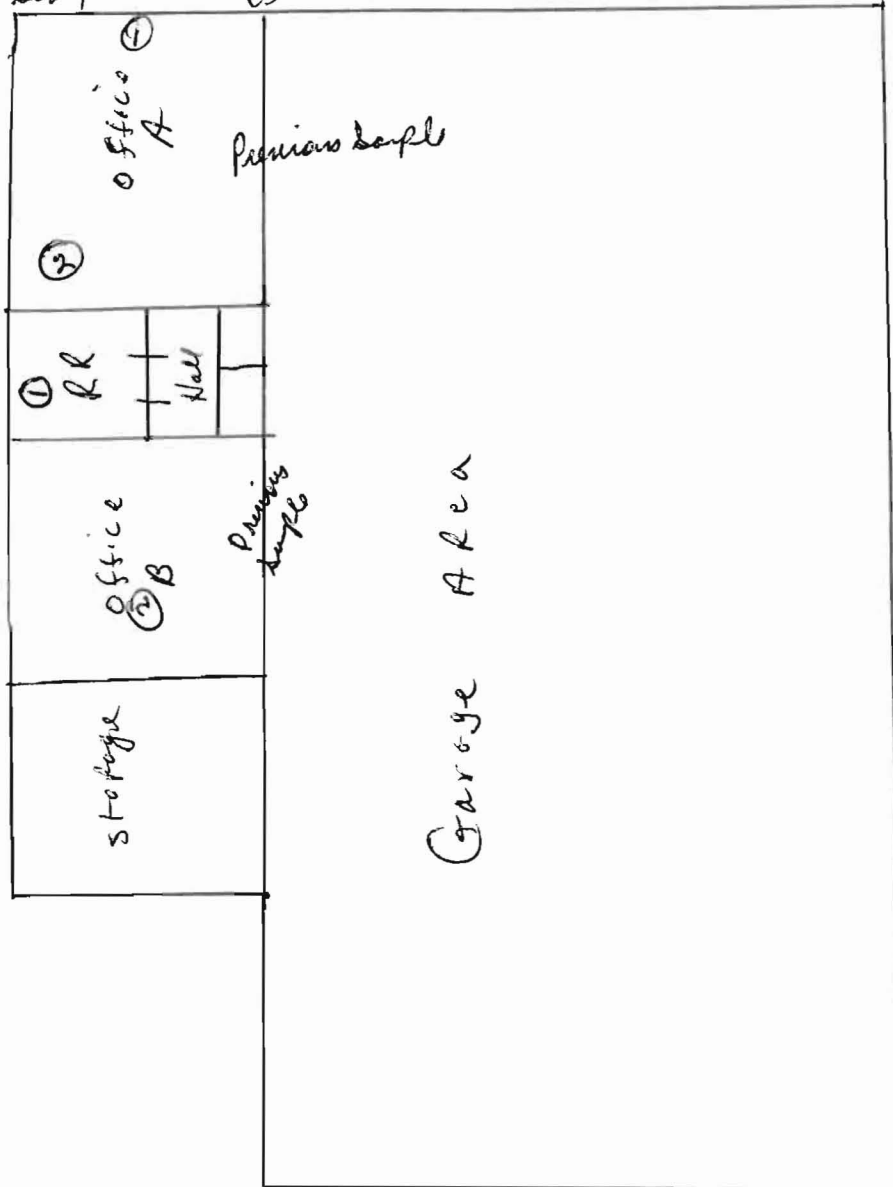



# NATIONAL LABORATORIES, INC.

Rivercity One  
3210 Claremont Ave.  
Evansville, IN 47712-4968  
Ph.: (812) 464-9000  
Fax: (812) 465-5746

NIST NVLAP #1658

NIOSH PAT #47712-001

## ANALYSIS REPORT

Sample Type: Bulk  
Set #: 3603  
Lab ID: 35383  
Client ID: 2 HA-4  
Other ID: Bus George RR -  
Ceiling Tile  
Date Received: 05-22-95  
Date Analyzed: 05-24-95

Edmonson Co. Board of Education  
P.O. Box 129  
Brownsville, KY 42210

National Laboratories, A Division of Consolidated Recycling Co., Inc., is accredited by the National Institute of Standards and Technology, National Voluntary Laboratory Accreditation Program, Lab ID #1658, for selected test method "40 CFR Chapter I (7-1-92 edition) Part 763, Subpart F, Appendix A", pages 546-551.

Sample Description: Tan/gold fibrous material with adhering paint

### ASBESTOS MINERALS

### ESTIMATED PERCENT

None Detected

### NON ASBESTOS COMPONENTS

### ESTIMATED PERCENT

Cellulose

99%

Paint

1%

**NOTE:** Sample percentage can vary due to analyst subjectivity.

**Remarks:** This test report relates only to the items tested and cannot be used for product endorsement by NVLAP or any agency of the U.S. Government. This sample will be disposed of by National Laboratories unless otherwise notified by client within ninety (90) days.

National Laboratories accepts full technical responsibility for this test report. Any questions concerning this report should be directed to Mr. David M. Cressler, P.E. This report must not be reproduced except in full.

Analyst

*Sharon Hunt*

**A DIVISION OF CONSOLIDATED RECYCLING CO., INC.**



# NATIONAL LABORATORIES, INC.

NIST NVLAP #1658

NIOSH PAT #47712-001

Rivercity One  
3210 Claremont Ave.  
Evansville, IN 47712-4968  
Ph.: (812) 464-9000  
Fax: (812) 465-5746

## ANALYSIS REPORT

Sample Type: Bulk  
Set #: 3603  
Lab ID: 35380  
Client ID: 1-HA3  
Other ID: Bus George Office A -  
Ceiling Tile  
Date Received: 05-22-95  
Date Analyzed: 05-24-95

Edmonson Co. Board of Education  
P.O. Box 129  
Brownsville, KY 42210

National Laboratories, A Division of Consolidated Recycling Co., Inc., is accredited by the National Institute of Standards and Technology, National Voluntary Laboratory Accreditation Program, Lab ID #1658, for selected test method "40 CFR Chapter I (7-1-92 edition) Part 763, Subpart F, Appendix A", pages 546-551.

Sample Description: Brown fibrous material with adhering paint

### ASBESTOS MINERALS

### ESTIMATED PERCENT

None Detected

### NON ASBESTOS COMPONENTS

### ESTIMATED PERCENT

Cellulose

97%

Paint

3%

**NOTE:** Sample percentage can vary due to analyst subjectivity.

**Remarks:** This test report relates only to the items tested and cannot be used for product endorsement by NVLAP or any agency of the U.S. Government. This sample will be disposed of by National Laboratories unless otherwise notified by client within ninety (90) days.

National Laboratories accepts full technical responsibility for this test report. Any questions concerning this report should be directed to Mr. David M. Cressler, P.E. This report must not be reproduced except in full.

Analyst

*Sharon Hunt*

**A DIVISION OF CONSOLIDATED RECYCLING CO., INC.**



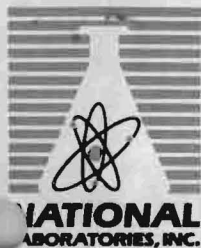

# NATIONAL LABORATORIES, INC.

NIST NVLAP #1658

NIOSH PAT #47712-001

Rivercity One  
3210 Claremont Ave.  
Evansville, IN 47712-4968  
Ph.: (812) 464-9000  
Fax: (812) 465-5746

## ANALYSIS REPORT

Sample Type: Bulk  
Set #: 3603  
Lab ID: 35382  
Client ID: 1 HA-4  
Other ID: Bus George Office B -  
Ceiling Tile  
Date Received: 05-22-95  
Date Analyzed: 05-24-95

Edmonson Co. Board of Education  
P.O. Box 129  
Brownsville, KY 42210

National Laboratories, A Division of Consolidated Recycling Co., Inc., is accredited by the National Institute of Standards and Technology, National Voluntary Laboratory Accreditation Program, Lab ID #1658, for selected test method "40 CFR Chapter I (7-1-92 edition) Part 763, Subpart F, Appendix A", pages 546-551.

Sample Description: Tan/gold fibrous material with adhering paint

### ASBESTOS MINERALS

### ESTIMATED PERCENT

None Detected

### NON ASBESTOS COMPONENTS

### ESTIMATED PERCENT

Cellulose

99%

Paint

1%

**NOTE:** Sample percentage can vary due to analyst subjectivity.

**Remarks:** This test report relates only to the items tested and cannot be used for product endorsement by NVLAP or any agency of the U.S. Government. This sample will be disposed of by National Laboratories unless otherwise notified by client within ninety (90) days.

National Laboratories accepts full technical responsibility for this test report. Any questions concerning this report should be directed to Mr. David M. Cressler, P.E. This report must not be reproduced except in full.

Analyst Sharon Hunt

**A DIVISION OF CONSOLIDATED RECYCLING CO., INC.**

# Edmonson Co. Bus Garage

104 Maple Street Brownsville, Ky.

Unit 5

(2) Samples taken 5/19/95 of Ceiling Tile Office B + RR + Hall

Unit 4

(2) " " " " " "

Office A

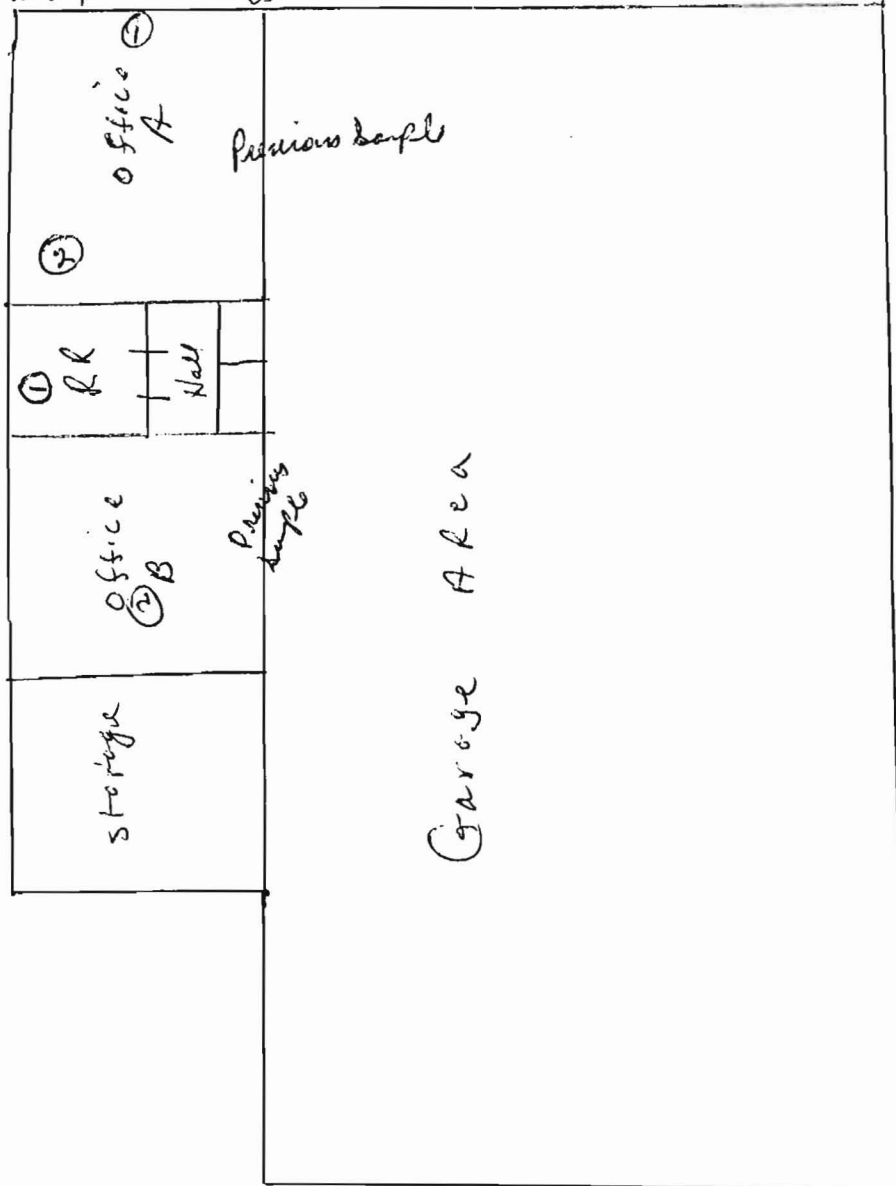

Samples taken by  
Billy H. Clemmons

## AHERA REINSPECTION REPORT - KENTUCKY

LEA Edmonson County Schools SCHOOL Bus Garage

**Introduction.** The Asbestos Hazard Emergency Response Act (AHERA) requires Local Education Agencies (LEAs) to use accredited inspectors to reinspect asbestos-containing building materials (ACBM) which were identified in previous AHERA inspection(s). Reinspection are required at least once every three years after the management plan goes into effect for those school buildings whose last inspection/reinspection identified ACBM. For most schools, this means reinspection must be done by July 9, 1992, and the results submitted to the LEA and the Division of Air Quality within 30 days after the reinspection. Results would include information regarding (1) reinspected and newly discovered ACBM (amounts, assessments, sampling information, etc.); (2) any needed revisions by accredited management planners and LEAs to response actions planned; (3) records of periodic surveillance, O&M training, O&M activities, fiber releases, and response actions taken; and (4) accreditations, assurances, annual plan-availability notifications to parents and employees, and other AHERA-required information.

Instructions for completing this form: Complete either item I. or item II., below, as appropriate. Do not complete this form if no ACBM was identified in the last inspection/reinspection.

- I. Reinspection results show no change to information in existing management plan. (If checked, then accredited inspector needs to attach a newly completed Form 5.0 and current accreditation certificates, and LEA representatives and inspector need to sign the assurances immediately below. Also include in the submittal the information identified in items (3) and (4), above.)

I affirm that an accredited AHERA inspector has reinspected all confirmed and assumed ACBM identified in previous AHERA inspections/reinspections and, if applicable, has verified (attach verification) removal of previously identified ACBM which has removed since the last inspection/reinspection.

Accredited Inspector's Signature/Date \_\_\_\_\_

LEA Designated Person's Signature/Date \_\_\_\_\_

LEA Superintendent's Signature/Date \_\_\_\_\_

Reinspection Date \_\_\_\_\_

- x   II. Reinspection reports show change to information in management plan. (If checked, then the items identified in I., above, must be submitted, along with all revised or new homogeneous area forms, revised or new responses recommended by management planner and selected by LEA, and sampling methodology and results.)

Number of 6.0 Forms attached       1       (one for each homogeneous area, or HA)

Number of 6.1 Forms attached \_\_\_\_\_

Number of 3.0 Forms attached \_\_\_\_\_

Number of 3.1 Forms attached \_\_\_\_\_ (one for each response in each HA)

Number of samples taken       0      

I affirm that an accredited AHERA inspector has reinspected all confirmed and assumed ACBM identified in previous AHERA inspections/reinspection and has verified (attach verification) removal of previously identified ACBM which was removed since the last inspection/reinspection.

Accredited Inspector's Signature/Date Wallace Lyle 6/2/92

LEA Designated Person's Signature/Date Billy H. Clemens 6/5/92

Accredited Management Planner's Signature/Date Wallace Lyle 6/2/92

LEA Superintendent's Signature/Date John Hall 6-8-92

Reinspection Date 04/22/92 Effective Date of Management Plan Revisions 06/01/92



## BUILDING STATISTICS (OPTIONAL)

DATE BUILT	AREA NAME, ADDITION, WING ETC.	USE	TOTAL AREA	FLOORS

NOTES:

## CONSTRUCTION INFORMATION (OPTIONAL)

WALLS: ☐ Masonry Veneer  
☐ Solid Masonry/ Conc.  
☐ Wood  
☐ Other

FLOOR STRUCTURE: ☐ Wood  
☐ Concrete  
☐ Steel  
☐ Other

ROOF STRUCTURE: ☐ Wood  
☐ Concrete  
☐ Steel  
☐ Other

NOTES:

## DOCUMENT SUMMARY (OPTIONAL)

☐ Floor Plans  
☐ Sections  
☐ Finish Schedules

☐ Specifications  
☐ Mech. Drawings  
☐ As Built Drawings

☐ Past Surveys  
☐ In-House Sampling Reports  
☐ Past Abatement Projects

☐ Past Abatement Specifications  
☐ Past Abatement Drawings

## INSPECTION INFORMATION

ATTACH COPY OF TRAINING COURSE CERTIFICATE FOR EACH MEMBER

04/22/92  
 SURVEY DATE(S)

TEAM MEMBERS (PRINT OR TYPE)  
 Wallace Lyle

SIGNATURE

*Wallace Lyle*

ACCREDITATION NO.  
 P92-02-0091

TITLE  
 Mgt. Planner

SURVEY TIME(S)

## SCHOOL INFORMATION FORM

LEA: Edmonson County Schools  
 LEA NAME

1 5 1  
 LEA NO.

SCHOOL: Bus Garage  
 SCHOOL NAME

9 9 9  
 SCHOOL NO.

ADDRESS: P. O. Box 129, Brownsville, KY 42210

EXPOSURE CONSIDERATIONS - OPTIONAL

(Rated 1 as Best & 5 as Worst)

A.DETERIORATION	G.LENGTH OF EXPOSURE	H.EXPOSURE POPULATION
B.PHYSICAL DAMAGE	1. 1 HR/WK	1. MAINT. ONLY
C.WATER DAMAGE	2. 5 HRS/WK	2. 1 & CUSTODIAN
D.ACTIVITY/VIBRATION	3. 10 HRS/WK	3. 2 & FACULTY
E.EXPOSURE	4. 20 HRS/WK	4. 3 & STUDENTS
F.ACCESSIBILITY	5. 40 HRS/WK	5. 4 & PUBLIC

ASSESSMENT CATEGORIES

- 1- Damaged/significantly damaged TSI
- 2- Damaged friable SURFACING ACM
- 3- Significantly damaged friable SURFACING ACM
- 4- Damaged or significantly damaged friable MISCELLANEOUS ACM
- 5- ACM with potential for damage
- 6- ACM with potential for significant damage
- 7- Any remaining friable ACM or friable suspected ACM

SAMPLE NO.	BIA #	EXIST RM.#	INSPECTION AREA NAME	ASBESTOS TYPE/%	EXPOSURE CONSIDERATIONS								ASSMT. CAT.	QUANTITIES			TOTALS	
					A	B	C	D	E	F	G	H		LENGTH	WD.	DIA.	LF	SF
		A	Office Area										5	23	17			391

AREAS INCLUDED IN HOMOGENEOUS AREA

MISCELLANEOUS QUANTITY CALCULATIONS

GRAND TOTAL

391 Sq Ft

CONFIRMED ASSUMED NO ACM  
ACBM F ☐ NF ☐ F ☒ NF ☒

SAMPLING DATE: \_\_\_/\_\_\_/\_\_\_

INSPECTOR: Wallace Lyle

SIGNATURE: *Wallace Lyle*

LEA: Edmonson County Schools

SCHOOL: Bus Garage

NO. 1 5 1

NO. 9 9 9

MATERIAL DESCRIPTION/ADDITIONAL REASONS FOR ASSESSMENT

Lt. Brown Linoleum

HOMOGENEOUS AREA FORM

LEGEND

BIA# BUILDING INSPECTION AREA NUMBER  
INSPECTOR ASSIGNED NO. FOR CONTROL

THERMAL(TSI) ☐ SURFACING ☐ MISC. x

MAT.TYPE: Lt. Brown Linoleum

HA:

DRAWING NO.

GENERIC

ASSIGNED

# **Response Activities**

# KENTUCKY DIVISION FOR AIR QUALITY AHERA INSPECTION REPORT

I-Steps  
Excel  
8/27/01  
LLT

Page 1 of 2

AHERA Log # <b>A-151-273</b>		Complaint # <b>NA</b>		File # <u>21</u> / <u>061</u> / <b>ASBT</b>	
				<small>AQCR      County No.      Facility</small>	
Date <u>08</u> / <u>17</u> / <u>01</u>		Time <u>10:30</u> am to <u>      </u> am		Person contacted <u>Lannie Deweese</u>	
<small>Mo.      Day      Yr.</small>		<small>pm</small>		<small>pm</small>	
Title <u>LEA Designee/Maintenance Director</u>					
LEA Name <u>Edmonson County BOE</u> School/Contractor Name <u>bus garage</u>					
School Address <u>HWY 259 Brownsville, KY 42210</u>					
Plan available for inspection? <u>Y</u> Survey adequate? <u>Y</u> Warning signs posted? <u>NA</u>					
O & M activities/training records kept? <u>Y</u> List of trained O & M personnel? <u>Y</u>					
Periodic Surveillance OK? <u>Y</u> Annual Notices OK? <u>Y</u> Designated person OK? <u>Y</u>					
<b>Mngt. Planner(s)</b>		<b>(list most recent first)</b>		<b>Inspectors</b>	
<u>Lenora Nicol</u>		<u>4/30/01</u>		<u>same</u>	
<u>Lenora Nicol</u>		<u>6/11/98</u>		<u>same</u>	
<u>Billy Clemons</u>		<u>5/17/95</u>		<u>same</u>	
<p><b>Findings:</b></p> <p>The inspector met LEA Designee Lannie Deweese at the Edmonson County Schools bus garage. Mr. Deweese had copies of the Asbestos Management Plan for the bus garage. The inspector performed a review of the Plan. Periodic Surveillance was up to date with the last one performed during the three yr. re-inspection by Ms. Lenora Nicol, of Air Source Technologies, in April 2001. Annual Notification to Parents was also up to date with the notification for the current school year (2001-02) already included. Also included in the Plan was a list of trained personnel for all the schools' maintenance and custodial staff. This included training certificates for the LEA Designee, Mr. Deweese, and for all the past Inspector/Management Planners. The Plan also included an Operations &amp; Maintenance Plan for asbestos containing materials. Following a review of the plan, the inspector performed a brief walk-through of the bus garage. The only ACBM identified in the Plan for this building was the gold and yellow linoleum located throughout the office area. This material was in good condition.</p> <p><b>Regulations Violated:</b> <u>none</u></p>					
Recommended Corrective Action:					
Inspector's Signature <u>Laura R. Jomlin</u> Date: <u>27-Aug-01</u> ID # <u>48</u>					
I hereby acknowledge receipt of a copy of this report and do further acknowledge that I have been appraised of the findings and any alleged violations noted therein. <span style="float: right;">LLT</span>					
Signed <u>Copy mailed to Lannie Deweese</u> Date: <u>8/28/01</u>					
V		Office Use Only:			
NV <input checked="" type="checkbox"/> <input checked="" type="checkbox"/> <input checked="" type="checkbox"/> <input checked="" type="checkbox"/>					
NOV					
				IN-DEPTH INSPECTION: <u>no</u>	

## DIVISION FOR AIR QUALITY INSPECTION REPORT CONTINUATION SHEET

(Rev. 4-97)

Page 2 of 2

Facility Name Edmonson Co. Schools/ Bus GarageFile No. 21 / 061 / ASBT  
AQCR County No. Plant Id.Date of Action 0 8 / 1 7 / 0 1  
Mo. Day Yr.

Also tested was the 1x1 ceiling tile and exterior roofing and siding. These materials were NAD. The inspector did not observe any additional suspect materials. There were no response actions recorded for the bus garage. Mr. Deweese stated that the school system plans to build a new bus garage in the near future. GPS site coordinates were recorded at the bus garage. These were N37°11'30.0" W86°15'34.1".

\*\*\*Mr. Deweese also stated that copies of the Management Plan for each school were kept at the Edmonson County Schools Central Office. This is a requirement of the AHERA regulation.\*\*\*

Investigator's Signature

*Laura L. Tomlin*Title *Environmental Inspector III*

I hereby acknowledge receipt of a copy of this report and do further acknowledge that I have been apprised of the findings and any alleged violations noted therein.

Signed

Title



United States Environmental Protection Agency  
Washington, D.C. 20460  
Toxic Substances Control Act  
NOTICE OF INSPECTION

Form Approved  
OMB No. 2070-0007  
Approval Expires 07-31-96

The public reporting burden for this collection of information is estimated to average 5 minutes per response. This estimate includes time for reviewing instructions, searching existing data sources, gathering and maintaining the needed data, and completing and reviewing the collection of information. Send comments regarding the burden estimate or any other aspect of this collection of information to the Chief, Information Policy Branch (PM-223), US Environmental Protection Agency, 401 M Street, SW, Washington, DC 20460, and to the Office of Information and Regulatory Affairs, Office of Management and Budget, Washington, DC 20503, marked ATTENTION: Desk Officer for EPA.

1. Investigation Identification			2. Time	3. Firm Name
Date 8/17/01	Inspector No. 48	Daily Seq. No.	10:20AM	Edmonson Co. Bus Garage
4. Inspector Address Ky Division for Air Quality 1508 Western Ave. Bowling Green, Ky 42104				5. Firm Address Hwy 25A Bowlingville, KY 42210

REASON FOR INSPECTION

Under the authority of Section 11 of the Toxic Substances Control Act:

- ☐ For the purpose of inspecting (including taking samples, photographs, statements, and other inspection activities) an establishment, facility, or other premises in which chemical substances or mixtures or articles containing same are manufactured, processed or stored, or held before or after their distribution in commerce (including records, files, papers, processes, controls, and facilities) and any conveyance being used to transport chemical substances, mixtures, or articles containing same in connection with their distribution in commerce (including records, files, papers, processes, controls, and facilities) bearing on whether the requirements of the Act applicable to the chemical substances, mixtures, or articles within or associated with such premises or conveyance have been complied with.

☐ In addition, this inspection extends to (Check appropriate blocks):

☐ A. Financial data

☐ D. Personnel data

☐ B. Sales data

☐ E. Research data

☐ C. Pricing data

☒ F. AHERA inspection.

The nature and extent of inspection of such data specified in A through E above is as follows:

Certification

I certify that the statements I have made on this form and all attachments thereto are true, accurate, and complete. I acknowledge that any knowingly false or misleading statement may be punishable by fine or imprisonment or both under applicable law.

Inspector Signature Laura L. Tomlin		Recipient Signature Lannie Dewese	
Name Laura L. Tomlin		Name Lannie Dewese	
Title Env. Inspector III	Date Signed 8/17/01	Title Maintenance Director	Date Signed 8-17-2001

# **Original Management Plan**

# BUILDING STATISTICS

(OPTIONAL)

DATE BUILT	AREA NAME, ADDITION, WING, ETC.	USE	TOTAL AREA	FLOORS

NOTES:

# CONSTRUCTION INFORMATION

(OPTIONAL)

WALLS: ☐ Masonry Veneer  
☐ Solid Masonry / Conc.  
☐ Wood  
☐ Other

FLOOR STRUCTURE: ☐ Wood  
☐ Concrete  
☐ Steel  
☐ Other

ROOF STRUCTURE: ☐ Wood  
☐ Concrete  
☐ Steel  
☐ Other

NOTES:

# DOCUMENT SUMMARY

(OPTIONAL)

- |   |  |  |  |
|---|--|--|--|
| <input checked="" type="checkbox"/> Floor Plans | <input type="checkbox"/> Specifications    | <input checked="" type="checkbox"/> Past Surveys   | <input type="checkbox"/> Past Abatement Specifications |
| <input type="checkbox"/> Sections               | <input type="checkbox"/> Mech. Drawings    | <input type="checkbox"/> In-House Sampling Reports | <input type="checkbox"/> Past Abatement Drawings       |
| <input type="checkbox"/> Finish Schedules       | <input type="checkbox"/> As Built Drawings | <input type="checkbox"/> Past Abatement Projects   |  |

# INSPECTION INFORMATION

ATTACH COPY OF TRAINING COURSE CERTIFICATE FOR EACH MEMBER

SURVEY DATE (S)	TEAM MEMBERS (PRINT OR TYPE)	SIGNATURE	ACCREDITATION NO.	TITLE
8/9/88	Joe Richardson	<i>Joe Richardson</i>	1116	Inspector
	Duane Trimble	<i>Duane Trimble</i>	VIIKU86260-26	Inspector

# SCHOOL INFORMATION FORM

LEA: Edmonson County Schools 151  
 LEA NAME  
 (OR BUILDING NAME) SCHOOL: Bus Garage Site 999  
 SCHOOL NAME  
 ADDRESS: P.O. Box 129, Brownsville, KY 42210 999  
 SCHOOL NO



# TABLE OF CONTENTS

AHERA MANAGEMENT PLAN  
 KENTUCKY DEPT. OF EDUCATION  
 DIVISION OF BUILDINGS & GROUNDS

FORM NO.	TABLE OF CONTENTS
1.0	<b>A. MANAGEMENT PLAN COVER SHEET</b> (KEEP COPY AT EACH SCHOOL)
2.0	<b>B. SCHOOL BUILDINGS</b> LIST OF BUILDINGS - ASBESTOS PRESENCE
	<b>C. ACTIONS TO BE TAKEN (BY LEA)</b> (LEA NO.) (SCHOOL NAME) LIST IN THE SAME ORDER AS ON FORM 2.0
3.0	RESPONSE ACTIONS - SUMMARY - RECOMMENDED BY MANAGEMENT PLANNER ONE (1) FORM FOR EACH SCHOOL
3.1	RESPONSE ACTION - DETAILED DESCRIPTION (BY LEA) ONE (1) FORM FOR EACH RESPONSE ACTION (USE ADDITIONAL BLANK SHEETS IF NECESSARY)
4.0	FOLLOW-UP ACTIONS  (LEA NO.) (SCHOOL NAME) LIST EACH SCHOOL OR SEPARATE BUILDING ( BUS GARAGE, CENTRAL OFFICE, ETC.) LIST ALL INFORMATION IN THE ABOVE EXAMPLE
	<b>D. SCHOOL INFORMATION</b> (INFORMATION TO BE KEPT AT EACH SCHOOL) (LEA NO.) (SCHOOL NAME)
5.0	SCHOOL INFORMATION FORM
	ASSESSMENTS
6.0	HOMOGENEOUS AREA FORM ONE (1) FORM FOR EACH HOMOGENEOUS AREA
6.1	DRAWING OR DESCRIPTION OF EACH HOMOGENEOUS AREA ONE (1) DRAWING FOR EACH HOMOGENEOUS AREA
	RESPONSE ACTIONS
3.0	RESPONSE ACTIONS - SUMMARY (SAME AS ABOVE)
3.1	RESPONSE ACTION - DETAILED DESCRIPTION (SAME AS ABOVE)
4.0	FOLLOW-UP ACTIONS (SAME AS ABOVE)
	FUNCTIONAL SPACE INSPECTION FORM INSPECTOR'S FORM (FIELD GENERATED)
	BULK SAMPLE LOG INSPECTOR'S FORM (FIELD GENERATED)
	BULK SAMPLE ANALYSIS LABORATORY FORM
	(LEA NO.) (SCHOOL NAME) LIST EACH SCHOOL OR SEPARATE BUILDING ( BUS GARAGE, CENTRAL OFFICE, ETC.) LIST ALL INFORMATION IN THE ABOVE EXAMPLE
	<b>E. APPENDICES</b> <b>ACCREDITATION CERTIFICATES</b> INSPECTOR MANAGEMENT PLANNER

1. Damaged/significantly damaged TSI
2. Damaged friable SURFACING ACM
3. Significantly damaged friable SURFACING ACM
4. Damaged or significantly damaged friable MISCELLANEOUS ACM
5. ACBM with potential for damage
6. ACBM with potential for significant damage
7. Any remaining friable ACBM or friable suspected ACBM

### DESCRIPTION

MISC.

## Sq. Ft.

ASSESSMENT  
CATEGORY NO.

INST. PREVNT. MEAS.

## O & M PROGRAM

REPAIR

## ENCAPSULATE

**ENCLOSE**

**REMOVE**

ISOLATE

OTHER

START	COMPL.
DATE	DATE

[illegible]

## RECOMMENDED BY MANAGEMENT PLANNER

[Signature]  
MANAGEMENT PLANNER SIGNATURE

10/12/88  
DATE

- 999  
SCHOOL NO.

151  
LEA NO.

10/12/88  
MANAGEMENT PLAN DATE

## RESPONSE ACTION (RA)

USE ONE (1) SHEET FOR EACH DIFFERENT RESPONSE ACTION

☐

INSTITUTE PREVENTIVE MEASURES

☐

REPAIR

☐

ENCLOSE

☐

ISOLATE

☒

OPERATIONS & MAINTENANCE PROGRAM

☐

ENCAPSULATE

☐

REMOVE

☐

OTHER

DETAILED DESCRIPTION OF MARKED RESPONSE ACTION

1. INITIAL CLEANING
2. ADDITIONAL CLEANING AND REPAIRS AS NEEDED BUT AT LEAST ANNUALLY
3. STANDARD O & M PRACTICES TO BE FOLLOWED

## LOCATIONS

LIST ALL HOMOGENEOUS AREA NOS.; FUNCTIONAL SPACE NOS. OR ATTACH DRAWING

H.A. #1  
H.A. #2  
H.A. #3  
H.A. #4

## REASONS

GIVE REASONS FOR SELECTING RESPONSE ACTION (RA) (IF RA IS DIFFERENT FROM RECOMMENDATIONS ON FORM 3.0 - LIST REASONS FOR CHANGE)

NECESSARY TO ASSURE THAT FIBERS ARE NOT RELEASED INTO THE AIR

## SCHEDULE

STARTING DATE(S) & COMPLETION DATE(S) FOR RESPONSE ACTION

START JULY 9, 1989 COMPLETION-ON GOING UNLESS ASBESTOS IS REMOVED

## RESOURCES NEEDED

LOCAL DISTRICT PERSONEL TRAINED IN THE O & M PROGRAM

## RESPONSE ACTION

TO BE IMPLEMENTED BY LEA

SCHOOL: BUS GARAGE SITE

SCHOOL NAME

LEA: EDMONSON COUNTY SCHOOLS

LEA NAME

9 9 9  
SCHOOL NO.

1 5 1  
LEA NO.

10/12/88  
MANAGEMENT PLAN DATE

---

## NOTIFICATION PLAN

- 1) A notice of the availability of the management plan will be given to all parent, teacher, and employee organizations and published in either an LEA newsletter or the newspaper of widest circulation for the school district beginning in October, 1988, and continuing annually thereafter. A dated copy of this notice is included in the appendix.
- 2) Written notice to workers and building occupants will be posted at entrances and other conspicuous places, and updated at least annually with information about inspections, response actions, and post-response action activities, including periodic reinspection and surveillance activities that are planned or in progress.

---

## PERIODIC SURVEILLANCE PLAN

TO BE CONDUCTED AT LEAST EVERY 6 MONTHS AFTER THE EFFECTIVE DATE OF THE MANAGEMENT PLAN

A person designated by the LEA superintendent shall perform the six month surveillance activities beginning in October, 1989, and every six months or less thereafter. He shall record the date of the surveillance, his name, and any observable changes in the condition of the material and submit this information to the LEA Designated Person, for inclusion in the management plan.

---

## REINSPECTION PLAN

TO BE CONDUCTED EVERY 3 YEARS AFTER THE EFFECTIVE DATE OF THE MANAGEMENT PLAN

During the 1991-92 fiscal year and every 3 years thereafter the LEA will provide for reinspection of its buildings. The reinspection will be performed by accredited local school personnel or by an accredited contractor if trained local personnel are unavailable. A written inspection report will be provided to the LEA Designated Person for inclusion in the management plan.

---

## FOLLOW-UP ACTIONS

TO BE IMPLEMENTED BY LEA

SCHOOL:	Bus Garage Site	999
	SCHOOL NAME	SCHOOL NO
LEA:	Edmonson County Schools	151
	LEA NAME	LEA NO

10/12/88

MANAGEMENT PLAN DATE

BUILDING STATISTICS

(OPTIONAL)

DATE BUILT	AREA NAME, ADDITION, WING, ETC.	USE	TOTAL AREA	FLOORS

NOTES:

CONSTRUCTION INFORMATION

(OPTIONAL)

WALLS:	<input type="checkbox"/> Masonry Veneer	FLOOR STRUCTURE:	<input type="checkbox"/> Wood	ROOF STRUCTURE:	<input type="checkbox"/> Wood
	<input type="checkbox"/> Solid Masonry / Conc.		<input type="checkbox"/> Concrete		<input type="checkbox"/> Concrete
	<input type="checkbox"/> Wood		<input type="checkbox"/> Steel		<input type="checkbox"/> Steel
	<input type="checkbox"/> Other		<input type="checkbox"/> Other		<input type="checkbox"/> Other

NOTES:

DOCUMENT SUMMARY

(OPTIONAL)

<input checked="" type="checkbox"/> Floor Plans	<input type="checkbox"/> Specifications	<input checked="" type="checkbox"/> Past Surveys	<input type="checkbox"/> Past Abatement Specifications
<input type="checkbox"/> Sections	<input type="checkbox"/> Mech. Drawings	<input type="checkbox"/> In-House Sampling Reports	<input type="checkbox"/> Past Abatement Drawings
<input type="checkbox"/> Finish Schedules	<input type="checkbox"/> As Built Drawings	<input type="checkbox"/> Past Abatement Projects	

INSPECTION INFORMATION

ATTACH COPY OF TRAINING COURSE CERTIFICATE FOR EACH MEMBER

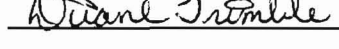
	TEAM MEMBERS (PRINT OR TYPE)	SIGNATURE	ACCREDITATION NO.	TITLE
8/9/88	Joe Richardson		1116	Inspector
SURVEY DATE (S)	Duane Trimble		VIKU86260-26	Inspector

SCHOOL INFORMATION FORM

LEA:	Edmonson County Schools	151
	LEA NAME	LEA NO.
(OR BUILDING NAME) SCHOOL:	Bus Garage Site	999
	SCHOOL NAME	SCHOOL NO.
ADDRESS:	P.O. Box 129, Brownsville, KY 42210	

**EXPOSURE CONSIDERATIONS - OPTIONAL** (Rated 1 as Best & 5 as Worst)

- |                              |                              |   |
|------------------------------|------------------------------|---|
| <b>A. DETERIORATION</b>      | <b>G. LENGTH OF EXPOSURE</b> | <b>H. EXPOSURE POPULATION (Personnel)</b> |
| <b>B. PHYSICAL DAMAGE</b>    | 1. 1 HOUR/WEEK               | 1. MAINTENANCE ONLY                       |
| <b>C. WATER DAMAGE</b>       | 2. 5 HRS/WK                  | 2. MAINT., CUSTODIAN                      |
| <b>D. ACTIVITY/VIBRATION</b> | 3. 10 HRS/WK                 | 3. MAINT., CUST., FACULTY                 |
| <b>E. EXPOSURE</b>           | 4. 20 HRS/WK                 | 4. MAINT., CUST., FAC., STUDENTS          |
| <b>F. ACCESSIBILITY</b>      | 5. 40 HRS/WK                 | 5. MAINT., CUSTD., FAC., STDS., PUBLIC    |

**ASSESSMENT CATEGORIES**

- 1 - Damaged/significantly damaged TSI
- 2 - Damaged friable SURFACING ACM
- 3 - Significantly damaged friable SURFACING ACM
- 4 - Damaged or significantly damaged friable MISCELLANEOUS ACM
- 5 - ACBM with potential for damage
- 6 - ACBM with potential for significant damage
- 7 - Any remaining friable ACBM or friable suspected ACBM

SAMPLE NO.	BIA #	EXIST RM.#	INSPECTION AREA NAME	ASBESTOS TYPE / %	EXPOSURE CONSIDERATIONS								ASSMT. CAT.	QUANTITIES			TOTALS	
					A	B	C	D	E	F	G	H		LENGTH	WD.	DIA.	LF	SF
2595	1	A	office & rr	0%									5	24	18			432

AREAS INCLUDED IN HOMOGENEOUS AREA

MISCELLANEOUS QUANTITY CALCULATIONS

GRAND TOTAL

432

SQ.FT.

LIN.FT.

ACBM

CONFIRMED

ASSUMED

NO ACBM

F ☐  
NF ☐

F ☐  
NF ☒

☐

SAMPLING DATE: 8/19/88

MATERIAL DESCRIPTION / ADDITIONAL REASONS FOR ASSESSMENT

INSPECTOR: Joe Richardson, Duane Trimble

Lt. Brown

SIGNATURE: *Joe Richardson* *Duane Trimble*

Assumed ACBM because only one sample was taken

LEA: Edmonson County Schools

151

LEA NAME

LEA NO.

SCHOOL: Bus Garage Site

999

SCHOOL NAME

SCHOOL NO.

**HOMOGENEOUS AREA FORM**

**LEGEND**

BIA# BUILDING INSPECTION AREA NUMBER  
INSPECTOR ASSIGNED NO. FOR CONTROL

THERMAL(TSI) ☐

SURFACING ☐

MISC. ☒

MAT.TYPE: inlaid linoleum

151-999-1  
DRAWING NO.

HA:

GENERIC

1  
ASSIGNED

## - OPTIONAL (Rated 1 as Best &amp; 5 as Worst)

1. MAINTENANCE ONLY
2. MAINT., CUSTODIAN
3. MAINT.,CUST.,FACULTY
4. MAINT.,CUST.,FAC., STUDENTS
5. MAINT., CUSTD., FAC.,STDS.,PUBLIC

- 1 - Damaged/significantly damaged TSI
- 2 - Damaged friable SURFACING ACM
- 3 - Significantly damaged friable SURFACING ACM
- 4 - Damaged or significantly damaged friable MISCELLANEOUS ACM
- 5 - ACBM with potential for damage
- 6 - ACBM with potential for significant damage
- 7 - Any remaining friable ACBM or friable suspected ACBM

### AREAS INCLUDED IN HOMOGENEOUS AREA

### MISCELLANEOUS QUANTITY CALCULATIONS

**GRAND TOTAL**

306	
-----	--

SQ.FT.

LIN.FT.

**CONFIRMED**

ASSUMED

NO ACBM

ACBM

**F**

NF

F

NF

[illegible]

SAMPLING DATE: 8-19-88

INSPECTOR: Joe Richardson, Duane Trimble

SIGNATURE:

LEA: Edmonson County Schools

LEA NAME

SCHOOL: Bus Garage Site

**SCHOOL NAME**

151

LEA NO.

999

SCHOOL NO. \_\_\_\_\_

## MATERIAL DESCRIPTION / ADDITIONAL REASONS FOR ASSESSMENT

dk brown

## HOMOGENEOUS AREA FORM

### LEGEND

BLAF BUILDING INSPECTION AREA NUMBER  
INSPECTOR ASSIGNED NO. FOR CONTROL

**THERMAL(TSI)**

--	--

## SURFACING

[illegible]

MISC.

• ☐

**MAT.TYPE:** Inlaid linoleum

151-999-1

DRAWING NO.

HA:

GENERIC

2

ASSIGNED

## EXPOSURE CONSIDERATIONS

- OPTIONAL (Rated 1 as Best & 5 as Worst)

## ASSESSMENT CATEGORIES

- 1 - Damaged/significantly damaged TSI
- 2 - Damaged friable SURFACING ACM
- 3 - Significantly damaged friable SURFACING ACM
- 4 - Damaged or significantly damaged friable MISCELLANEOUS ACM
- 5 - ACBM with potential for damage
- 6 - ACBM with potential for significant damage
- 7 - Any remaining friable ACBM or friable suspected ACBM

- |                       |                       |  |
|-----------------------|-----------------------|--|
| A. DETERIORATION      | G. LENGTH OF EXPOSURE | H. EXPOSURE POPULATION (Personnel)     |
| B. PHYSICAL DAMAGE    | 1. 1 HOUR/WEEK        | 1. MAINTENANCE ONLY                    |
| C. WATER DAMAGE       | 2. 5 HRS/WK           | 2. MAINT., CUSTODIAN                   |
| D. ACTIVITY/VIBRATION | 3. 10 HRS/WK          | 3. MAINT., CUST., FACULTY              |
| E. EXPOSURE           | 4. 20 HRS/WK          | 4. MAINT., CUST., FAC., STUDENTS       |
| F. ACCESSIBILITY      | 5. 40 HRS/WK          | 5. MAINT., CUSTD., FAC., STDS., PUBLIC |

[illegible]

### AREAS INCLUDED IN HOMOGENEOUS AREA

### MISCELLANEOUS QUANTITY CALCULATIONS

**GRAND TOTAL**

306

LIN. FT.

CONFIRMED

ASSUMED

NO ACBM

ACBM

F

F

NF

11

SAMPLING DATE: 8/19/88

MATERIAL DESCRIPTION / ADDITIONAL REASONS FOR ASSESSMENT

INSPECTOR: Joe Richardson, Duane Trimble

INSPECTOR: Joe Richardson, Duane Trimble  
SIGNATURE: Joe Richardson Duane Trimble

LEA:	Edmonson County Schools	151
	LEA NAME	LEA NO

SCHOOL: Bus Garage Site 999

White/smooth

Assumed ACBM because only one sample was taken

## HOMOGENEOUS AREA FORM

### LEGEND

BIA# BUILDING INSPECTION AREA NUMBER  
INSPECTOR ASSIGNED NO. FOR CONTROL

THERMAL(TSI)

## SURFACING

MISC. ☒

MAT.TYPE: 1x1 ceiling tile

151-999-1

HA:

## GENERIC

**ASSIGNED**



**EXPOSURE CONSIDERATIONS - OPTIONAL** (Rated 1 as Best & 5 as Worst)

- | A. DETERIORATION      | G. LENGTH OF EXPOSURE | H. EXPOSURE POPULATION (Personnel)     |
|-----------------------|-----------------------|--|
| B. PHYSICAL DAMAGE    | 1. 1 HOUR/WEEK        | 1. MAINTENANCE ONLY                    |
| C. WATER DAMAGE       | 2. 5 HRS/WK           | 2. MAINT., CUSTODIAN                   |
| D. ACTIVITY/VIBRATION | 3. 10 HRS/WK          | 3. MAINT., CUST., FACULTY              |
| E. EXPOSURE           | 4. 20 HRS/WK          | 4. MAINT., CUST., FAC., STUDENTS       |
| F. ACCESSIBILITY      | 5. 40 HRS/WK          | 5. MAINT., CUSTO., FAC., STDS., PUBLIC |

## ASSESSMENT CATEGORIES

- 1 - Damaged/significantly damaged TSI
- 2 - Damaged friable SURFACING ACM
- 3 - Significantly damaged friable SURFACING ACM
- 4 - Damaged or significantly damaged friable MISCELLANEOUS ACM
- 5 - ACBM with potential for damage
- 6 - ACBM with potential for significant damage
- 7 - Any remaining friable ACBM or friable suspected ACBM

[illegible]

SAMPLING DATE: 8/19/88

INSPECTOR: Joe Richardson, Duane Trimble

SIGNATURE: *Joe Richardson* *Duane Trimble*

LEA: Edmonson County Schools 151

LEA NAME LEA NO.

SCHOOL: Bus Garage Site 999

SCHOOL NAME SCHOOL NO.

MATERIAL DESCRIPTION / ADDITIONAL REASONS FOR ASSESSMENT

White/dotted  
Assumed ACBM because only one sample was taken

## HOMOGENEOUS AREA FORM

### LEGEND

BIA# BUILDING INSPECTION AREA NUMBER  
INSPECTOR ASSIGNED NO. FOR CONTROL

THERMAL(TSI) ☐ SURFACING ☐ MISC. ☒

MAT.TYPE: 1x1 ceiling tile

151-999-1      HA:      4  
DRAWING NO.      GENERIC      ASSIGNED

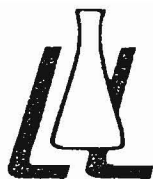

# Larron Laboratory

General Office: 529 Broadway / Cape Girardeau, Missouri / 63701 / 314-334-8910  
Branch Office: 711 W. Broadway / Mayfield, Kentucky / 42066 / 502-247-6982

Div. of MEAD  
Technologies, Inc.

## ANALYTICAL TESTING AND CONSULTING

September 20, 1988

KEDC  
440 Bellefonte St.  
Russell, Ky. 41169  
Att: Stan Rigg

EDMONSON COUNTY

Invoice# KB-209  
ASB #88M-2053  
Bulk Samples  
PO# GF0092

KEDC

Page 1 of 10

The bulk samples received on September 2, 1988, were analyzed in accordance with EPA Method 600/M4-020, polarized light microscopy with dispersion staining.

<u>SAMPLE ID</u>	<u>LOCATION</u>	<u>CONTENTS</u>
# 1	2748 —	2% chrysotile (mastic)
# 2	2517 —	No fibers detected No asbestos detected
# 3	2550 —	20% chrysotile
# 4	2694 —	No fibers detected No asbestos detected
# 5	2771 —	2% cellulose No asbestos detected
# 6	2596 —	3% chrysotile
# 7	2479 —	No fibers detected No asbestos detected
# 8	2640 —	35% chrysotile
# 9	2600 —	55% cellulose No asbestos detected
#10	2577 —	30% chrysotile
#11	2812 —	2% chrysotile (mastic)
#12	2650 —	10% fiberglass No asbestos detected
#13	2740 —	2% chrysotile
#14	2541 —	60% cellulose No asbestos detected



# Larron Laboratory

General Office: 529 Broadway / Cape Girardeau, Missouri / 63701 / 314-334-8910  
Branch Office: 711 W. Broadway / Mayfield, Kentucky / 42066 / 502-247-6982

Div. of MEAD  
Technologies, Inc.

## ANALYTICAL TESTING AND CONSULTING

KEDC

Page 2 of 10

#15	2598 —	40% syn. fibers No asbestos detected
#16	2610 —	10% cellulose No asbestos detected
#17 —	2772 —	3% chrysotile (mastic)
#18	2454 —	2% chrysotile (mastic)
#19	2646 —	No fibers detected No asbestos detected
#20	2515 —	40% fiberglass No asbestos detected
#21	2737 —	No fibers detected No asbestos detected
#22	2835 —	No fibers detected No asbestos detected
#23	2767 —	15% cellulose & 10% fiberglass No asbestos detected
#24	2601 —	3% cellulose & 1% fiberglass No asbestos detected
#25	2623 —	30% syn. fibers No asbestos detected
#26	2714 —	40% cellulose & 40% fiberglass No asbestos detected
#27	2729 —	40% cellulose & 40% fiberglass No asbestos detected
#28	2680 —	50% cellulose & 30% fiberglass No asbestos detected
#29	2585 —	5% cellulose & 30% fiberglass No asbestos detected
#30	2690 —	45% cellulose & 45% fiberglass No asbestos detected
#31	2686 —	15% fiberglass No asbestos detected
#32	2662 —	No fibers detected No asbestos detected



# Larron Laboratory

General Office: 529 Broadway / Cape Girardeau, Missouri / 63701 / 314-334-8910  
Branch Office: 711 W. Broadway / Mayfield, Kentucky / 42066 / 502-247-6982

Div. of MEAD  
Technologies, Inc.

## ANALYTICAL TESTING AND CONSULTING

KEDC

Page 3 of 10

#33	2689 —	3% chrysotile
#34	2779 ✓	1% cellulose & 1% fiberglass No asbestos detected
#35	2777 ✓	20% fiberglass No asbestos detected
#36	2617 —	98% cellulose No asbestos detected
#37	2765 ~	3% chrysotile
#38	2691-2671 —	3% chrysotile
#39	2497 —	5% cellulose No asbestos detected
#40	2783 —	2% chrysotile (mastic)
#41	2673 —	15% cellulose & 5% fiberglass No asbestos detected
#42	2651 —	55% cellulose No asbestos detected
#43	2791 —	60% cellulose No asbestos detected
#44	2641 —	45% chrysotile
#45	2667 —	40% cellulose & 45% fiberglass No asbestos detected
#46	2668 —	90% fiberglass No asbestos detected
#47	2731 —	No fibers detected No asbestos detected
#48	2629 —	No fibers detected No asbestos detected
#49	2696 —	No fibers detected No asbestos detected
#50	2697 —	98% cellulose No asbestos detected

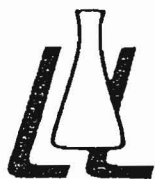

# Larron Laboratory

General Office: 529 Broadway / Cape Girardeau, Missouri / 63701 / 314-334-8910  
Branch Office: 711 W. Broadway / Mayfield, Kentucky / 42066 / 502-247-6982

Div. of MEAD  
Technologies, Inc.

## ANALYTICAL TESTING AND CONSULTING

KEDC

Page 4 of 10

#51	2678 —	2% chrysotile (mastic)
#52	2761 —	2% chrysotile (mastic)
#53	2704 —	3% cellulose No asbestos detected
#54 —	2730 —	20% fiberglass No asbestos detected
#55	2687 —	2% chrysotile (mastic)
#56	2564 —	15% cellulose & 5% fiberglass No asbestos detected
#57	2705 —	65% chrysotile
#58	2677 —	20% chrysotile (backing)
#59	2534 —	No fibers detected No asbestos detected
#60	2766 —	3% chrysotile
#61	2712 —	30% fiberglass No asbestos detected
#62	2717 —	3% chrysotile
#63	2759 —	75% chrysotile
#64 —	2675-2765 —	No fibers detected No asbestos detected
#65	2790 —	1% cellulose No asbestos detected
#66	2607 —	3% chrysotile
#67	2674 —	98% cellulose No asbestos detected
#68	2676 —	No fibers detected No asbestos detected
#69	2465 —	40% cellulose & 45% fiberglass No asbestos detected
#70	2679 —	25% cellulose & 5% fiberglass No asbestos detected



# Larron Laboratory

General Office: 529 Broadway / Cape Girardeau, Missouri / 63701 / 314-334-8910  
Branch Office: 711 W. Broadway / Mayfield, Kentucky / 42066 / 502-247-6982

Div. of MEAD  
Technologies, Inc.

## ANALYTICAL TESTING AND CONSULTING

KEDC

Page 5 of 10

#71	2780 —	2% chrysotile (mastic)
#72	2825 —	No fibers detected No asbestos detected
#73	2685 —	10% chrysotile
#74	2615 —	4% chrysotile
#75	2462 —	2% cellulose No asbestos detected
#76	2519 —	20% chrysotile
#77	2822 —	No fibers detected No asbestos detected
#78	2514 —	No fibers detected No asbestos detected
#79	2727 —	35% synthetic fibers No asbestos detected
#80	2527 —	3% cellulose No asbestos detected
#81	2626 —	No fibers detected No asbestos detected
#82	2713 —	25% cellulose & 5% fiberglass No asbestos detected
#83	2736 —	2% chrysotile (mastic)
#84	2484-2784 —	15% chrysotile
#85	2568 —	40% cellulose & 45% fiberglass No asbestos detected
#86	2655 —	2% chrysotile (mastic)
#87	2652 —	15% cellulose 5% fiberglass No asbestos detected
#88	2747 —	10% cellulose & 10% fiberglass No asbestos detected
#89	2467 —	25% chrysotile (backing)
#90	2573 —	No fibers detected No asbestos detected



# Larron Laboratory

General Office: 529 Broadway / Cape Girardeau, Missouri / 63701 / 314-334-8910  
Branch Office: 711 W. Broadway / Mayfield, Kentucky / 42066 / 502-247-6982

Div. of MEAD  
Technologies, Inc.

## ANALYTICAL TESTING AND CONSULTING

KEDC

Page 6 of 10

#91	2589 —	98% cellulose No asbestos detected
#92	2719 —	5% cellulose & 20% fiberglass No asbestos detected
#93	2452 —	No fibers detected No asbestos detected
#94	2520 —	15% cellulose No asbestos detected
#95	2723 —	55% cellulose No asbestos detected
#96	2691 —	5% cellulose No asbestos detected
#97	2444 —	2% chrysotile
#98	2769 —	2% chrysotile
#99	2645 —	2% chrysotile (mastic)
#100	2549 —	No fibers detected No asbestos detected
#101	2450 —	No fibers detected No asbestos detected
#102	2720 —	3% cellulose No asbestos detected
#103	2764 —	40% cellulose 45% fiberglass No asbestos detected
#104	2621 —	40% cellulose & 45% fiberglass No asbestos detected
#105	2773 —	3% cellulose & 15% fiberglass No asbestos detected
#106	2613 —	4% chrysotile
#107	2636 —	98% cellulose No asbestos detected
#108	2470 —	5% cellulose & 15% fiberglass No asbestos detected



# Larron Laboratory

General Office: 529 Broadway / Cape Girardeau, Missouri / 63701 / 314-334-8910  
Branch Office: 711 W. Broadway / Mayfield, Kentucky / 42066 / 502-247-6982

Div. of MEAD  
Technologies, Inc.

## ANALYTICAL TESTING AND CONSULTING

KEDC

Page 7 of 10

#109	2661 —	40% cellulose & 45% fiberglass No asbestos detected
#110	2456 —	55% chrysotile
#111	2733 —	98% cellulose No asbestos detected
#112	2660 —	2% cellulose No asbestos detected
#113	2726 —	40% cellulose & 45% fiberglass No asbestos detected
#114	2781 —	2% chrysotile
#115	2530 —	40% cellulose & 45% fiberglass No asbestos detected
#116	2775 —	No fibers detected No asbestos detected
#117	2443 —	20% cellulose No asbestos detected
#118	2758 —	No fibers detected No asbestos detected
#119	2588 —	2% chrysotile
#120	2631 —	45% cellulose & 40% fiberglass No asbestos detected
#121	2744 —	40% cellulose & 45% fiberglass No asbestos detected
#122	2491 —	No fibers detected No asbestos detected
#123	2397 —	No fibers detected No asbestos detected
#124	2539 —	2% chrysotile (mastic)
#125	2706 —	2% cellulose & 35% fiberglass No asbestos detected
#126	2745 —	98% cellulose No asbestos detected
#127	2770 —	25% fiberglass No asbestos detected





# Larron Laboratory

General Office: 529 Broadway / Cape Girardeau, Missouri / 63701 / 314-334-8910  
Branch Office: 711 W. Broadway / Mayfield, Kentucky / 42066 / 502-247-6982

Div. of MEAD  
Technologies, Inc.

## ANALYTICAL TESTING AND CONSULTING

KEDC

Page 8 of 10

#128	2637 —	2% cellulose No asbestos detected
#129	2817 —	2% cellulose No asbestos detected
#130	2688 —	15% cellulose No asbestos detected
#131	2716 —	2% chrysotile (mastic)
#132	2698 —	30% cellulose & 15% fiberglass No asbestos detected
#133	2710 —	10% cellulose No asbestos detected
#134	2787 —	3% chrysotile (mastic)
#135	2763 —	No fibers detected No asbestos detected
#136	2625 —	No fibers detected No asbestos detected
#137	2611 —	5% cellulose & 2% fiberglass No asbestos detected
#138	2630 —	45% cellulose & 30% fiberglass No asbestos detected
#139	2472 —	2% cellulose No asbestos detected
#140	2776 —	5% chrysotile
#141	2810 —	No fibers detected No asbestos detected
#142	2753 —	98% cellulose No asbestos detected
#143	2618 —	15% fiberglass No asbestos detected
#144	2725 —	3% chrysotile
#145	2692 —	15% chrysotile & 5% amosite
#146	2703 —	25% chrysotile



# Larron Laboratory

General Office: 529 Broadway / Cape Girardeau, Missouri / 63701 / 314-334-8910  
Branch Office: 711 W. Broadway / Mayfield, Kentucky / 42066 / 502-247-6982

Div. of MEAD  
Technologies, Inc.

## ANALYTICAL TESTING AND CONSULTING

KEDC

Page 9 of 10

#147	2681 —	4% chrysotile (backing)
#148	2620 —	No fibers detected No asbestos detected
#149	2683 —	98% fiberglass No asbestos detected
#150	2789 —	2% cellulose No asbestos detected
#151	2595 —	25% cellulose & 5% fiberglass No asbestos detected
#152	2813 —	3% chrysotile
#153	2693 —	3% chrysotile

*Brian Enoch*  
Brian Enoch  
Asbestos Technician

Daniel B. Roth  
Q.C. Officer

*Daniel B. Roth*  
Daniel B. Roth  
Manager, Branch Office



# Larron Laboratory

General Office: 529 Broadway / Cape Girardeau, Missouri / 63701 / 314-334-8910  
Branch Office: 711 W. Broadway / Mayfield, Kentucky / 42066 / 502-247-6982

Div. of MEAD  
Technologies, Inc.

## ANALYTICAL TESTING AND CONSULTING

September 30, 1988

KEDC  
440 Bellefonte St.  
Russell, Ky. 41169

EDMONSON COUNTY

Invoice #K8-228  
ASB #88M-2088  
Bulk Samples  
PO# GF 0128

KEDC

Page 1 of 3

The bulk samples received on September 27, 1988 were analyzed in accord with EPA Method 600/M4-020, polarized light microscopy with dispersion staining.

<u>SAMPLE ID</u>	<u>LOCATION</u>	<u>CONTENTS</u>
# 1	#2700 ✓	2% cellulose No asbestos detected
# 2	#2762 ✓	50% cellulose & 45% fiberglass No asbestos detected
# 3	#2682 ✓	15% cellulose No asbestos detected
# 4	#2500 ✓	20% cellulose & 20% fiberglass No asbestos detected
# 5	#2586 ✓	70% fiberglass
# 6	#2486 ✓	15% cellulose No asbestos detected
# 7	#2742 ✓	50% cellulose & 45% fiberglass No asbestos detected
# 8	#2594 ✓	2% chrysotile (mastic)
# 9	#2768 ✓	50% cellulose & 45% fiberglass No asbestos detected
# 10	#2582 ✓	2% chrysotile (mastic)
# 11	#2735 ✓	45% cellulose & 18% fiberglass No asbestos detected
# 12	#2788 ✓	No fibers detected No asbestos detected
# 13	#2458 ✓	50% cellulose & 45% fiberglass No asbestos detected

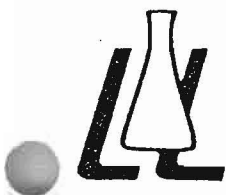

# Larron Laboratory

General Office: 529 Broadway / Cape Girardeau, Missouri / 63701 / 314-334-8910  
Branch Office: 711 W. Broadway / Mayfield, Kentucky / 42066 / 502-247-6982

Div. of MEAD  
Technologies, Inc.

## ANALYTICAL TESTING AND CONSULTING

KEDC

Page 2 of 3

# 14	#2666 ✓	No fibers detected No asbestos detected
# 15	#2634 ✓	No fibers detected No asbestos detected
# 16	#2635 ✓	2% chrysotile (mastic)
# 17	#2609 ✓	20% fiberglass No asbestos detected
# 18	#2774 ✓	5% cellulose & 40% fiberglass No asbestos detected
# 19	#2734 ✓	40% fiberglass No asbestos detected
# 20	#2792 ✓	2% cellulose No asbestos detected
# 21	#2602 ✓	50% cellulose & 45% fiberglass No asbestos detected
# 22	#2608 ✓	15% fiberglass No asbestos detected
# 23	#2784 ✓	50% cellulose & 45% fiberglass No asbestos detected
# 24	#2471 ✓	2% chrysotile
# 25	#2732 ✓	15% fiberglass No asbestos detected
# 26	#2136 ✓	98% cellulose No asbestos detected

*Brenda Barendregt*  
Brenda Barendregt  
Asbestos Technician

*Daniel B. Roth*  
Daniel B. Roth  
Q.C. Officer

*Daniel B. Roth*  
Daniel B. Roth  
Manager, Branch Office



# NATIONAL ASBESTOS TRAINING CENTER

The University of Kansas

D U A N E   K .   T R I M B L E

has completed a course and passed an examination in

## Inspection for Asbestos Control

DATE: JUNE 27 - 29, 1988

EXAM DATE: JUNE 29, 1988

NUMBER: VIIKU86260-26

EXPIRES: JULY 1, 1989

SOCIAL SECURITY #: 400-06-4396

*Lani Hume-garner*

Office of Continuing Education and Extension  
**College of Engineering**  
**University of Kentucky**  
**Lexington, Kentucky**



*This is to certify that*

STAN RIGGS

HAS PASSED THE EXAMINATION FOR

EPA ACCREDITED ASBESTOS INSPECTOR

ACCREDITATION NO. 1117

EXPIRATION DATE: FEBRUARY 17, 1989

  
Dean - College of Engineering

  
Associate Dean for Continuing Education

Office of Continuing Education and Extension  
**College of Engineering**  
**University of Kentucky**  
**Lexington, Kentucky**



*This is to certify that*

**JOE            RICHARDSON**

**HAS PASSED THE EXAMINATION FOR**

**EPA ACCREDITED ASBESTOS INSPECTOR**

**ACCREDITATION NO.    1116**

**EXPIRATION DATE: FEBRUARY 17, 1989**

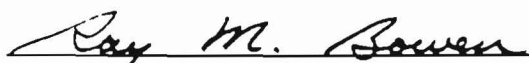
  
Dean - College of Engineering

  
Associate Dean for Continuing Education

Office of Continuing Education and Extension  
**College of Engineering**  
**University of Kentucky**  
**Lexington, Kentucky**



*This is to certify that*

**JOE RICHARDSON**

**HAS PASSED THE EXAMINATION FOR**

**EPA ACCREDITED MANAGEMENT PLANNER**

**ACCREDITATION NO. 1053**

**EXPIRATION DATE: FEBRUARY 19, 1989**

*Ray M. Bowen*  
Dean - College of Engineering

*David K. Blythe*  
Associate Dean for Continuing Education





UNITED STATES ENVIRONMENTAL PROTECTION AGENCY  
WASHINGTON, D.C. 20460

SEP 1 1988

OFFICE OF  
PESTICIDES AND TOXIC SUBSTANCES

4403

Daniel Roth, Branch Mgr.  
Larron Laboratory  
711 Broadway  
Mayfield, KY 42066

SUBJECT: EPA Interim Laboratory Accreditation for Laboratories  
Which Offer Analysis of Bulk Samples for Asbestos

Dear Laboratory Director:

The U.S. Environmental Protection Agency (EPA) has completed its review of the results of the second round of analyses in the EPA "Interim Asbestos Bulk Sample Analysis Quality Assurance Program." I am pleased to inform you that your laboratory has successfully classified each of four bulk samples submitted to your facility as either asbestos-containing or nonasbestos-containing. Since each sample was correctly classified, a status of "accredited" has been assigned to your laboratory. As you are aware, each laboratory is also given a numerical score which does not affect your accredited status. The numerical score reflects your laboratory's performance in determining the quantity and type of asbestos in the asbestos-containing samples. Your laboratory's score is 100%.

As announced in the FEDERAL REGISTER of March 29, 1988 (see enclosed copy), the second round of the EPA Interim Program is the last planned round of EPA accreditation. Laboratories which are accredited in the second round of this program will be considered accredited until January 12, 1989. The National Bureau of Standards (NBS) will begin formal operation of the National Voluntary Laboratory Accreditation Program (NVLAP) for laboratories which conduct analyses of bulk samples for asbestos by polarized light microscopy (PLM) in October 1988. Applications for participation in this program are currently being accepted. You may contact Dr. Larry Gallowin of NBS at (301)975-4022 for enrollment information. An exception to the EPA deadline of January 12, 1989 has been made for laboratories which are accredited in the second EPA round and have enrolled in the NBS program by September 30, 1988. These laboratories will be considered accredited by EPA until NBS has completed its first

evaluation of an individual laboratory's performance. The enclosed copy of the FEDERAL REGISTER notice details the period of transition from EPA accreditation to NBS accreditation. Please note that a laboratory currently accredited by EPA must enter the NBS program and receive accreditation from NBS to continue analysis of bulk samples from school buildings.

Should you have any questions regarding the current EPA round of accreditation, you may contact Bruce Harvey of Research Triangle Institute at (919) 541-6369. Thank you for your participation in the program.

Sincerely,



Martin P. Halper, Director  
Exposure Evaluation Division (TS-798)

Enclosure



UNITED STATES ENVIRONMENTAL PROTECTION AGENCY

WASHINGTON, D.C. 20460

DEC 24 1987

7376

David J. Roth  
Larron Laboratory  
529 Broadway  
Cape Girardeau, MO 63701

THE ADMINISTRATOR

SUBJECT: EPA Interim Laboratory Accreditation for Laboratories  
Which Offer Analysis of Bulk Samples for Asbestos

Dear Laboratory Director:

The U.S. Environmental Protection Agency (EPA) has completed its review of the results of the first round of analyses in the EPA "Interim Asbestos Bulk Sample Analysis Quality Assurance Program." I am pleased to inform you that your laboratory has successfully classified each of four bulk samples submitted to you as either asbestos-containing or nonasbestos-containing. Since each sample was correctly classified, a status of "accredited" has been assigned to your laboratory. As you are aware, each laboratory is also given a numerical score which does not affect its accredited status. The numerical score reflects your laboratory's performance in determining the quantity and type of asbestos in the asbestos-containing samples. Your laboratory's score is 100 %. For an explanation of this score, please consult the enclosed result sheets.

EPA will offer the second round of the laboratory accreditation program in April 1988. In April, all participating laboratories will be issued a set of four bulk samples. Laboratories which have successfully analyzed the samples in the current round must also correctly analyze each of the four samples in the April round in order to continue their accredited status. Hence, the accredited status you have earned in this round will be effective until July 12, 1988. Again, you must participate in the next round of analyses to be eligible for continued accreditation after July 12, 1988. Keep in mind that all laboratories which perform analyses for schools must be accredited.

Please be aware that the National Bureau of Standards' (NBS) National Voluntary Laboratory Accreditation Program (NVLAP) is currently accepting applications on a "first come, first served" basis for its October 1988 evaluation of laboratories which conduct bulk analyses. The existing EPA accreditation program will be discontinued next fall and accreditations received from EPA in June 1988 will not meet regulatory requirements at that time.

## Description of the Manner Utilized to Determine Sampling Locations

The following is a description of the manner utilized by the accredited inspector to determine the locations at which to take samples:

(a) Friable surfacing material. Bulk sample locations for homogenous areas of friable surfacing material were determined by the statistically random method defined in the EPA publication "Asbestos in Buildings: Simplified Sampling Scheme for Friable Surfacing Materials" (EPA 560/5-85-030a October 1985). Due to cost constraints only the minimum number of samples were collected for each homogenous area: three samples for each homogenous area of 1000 sq. ft. or less; five samples for areas between 1000 and 5000 sq. ft.; and seven samples for areas over 5000 sq. ft. The random sampling scheme and random number table described in the above referenced publication was used to determine the location that the samples were to be taken.

(b) Thermal system insulation. Bulk samples was taken from homogenous areas of thermal system insulation in locations that were determined in a randomly distributed manner that was representative of the homogenous area.

(c) Friable miscellaneous material and nonfriable suspected ACM. Bulk samples was taken from homogenous areas of friable miscellaneous material and nonfriable suspected ACM in locations that were determined in a randomly distributed manner that was representative of the homogenous area.

October 12, 1988

NOTICE

TO: All Edmonson County Schools Parent, Teacher,  
and Employee Organizations

FROM: Mr. David Webb, Supt., Edmonson County Schools

SUBJECT: Availability of Asbestos Management Plans

This is to inform all concerned parties of the availability of asbestos management plans for each school in the Edmonson County Schools.

The plans for each school are available for inspection during normal school hours in the school principal's office and at the superintendent's office. The plans for the school district central office and any other buildings not associated with a specific school are available at the superintendent's office.

**MANAGEMENT PLANNER (MP)**

(ATTACH COPY OF TRAINING COURSE CERTIFICATES IN APPENDICES)

MANAGEMENT PLANNER: Joe Richardson  
ADDRESS: 440 Bellefonte St., Russell, KY 41169  
PHONE NO.: (606)836-0204  
MP. SIGNATURE: *Joe Richardson* 10/12/88  
DATE

ACCREDITATION NO.: 1053  
TRAINING AGENCY: University of Kentucky  
TRAINING COURSE: Asbestos Management Planner  
COURSE DATE: February 15-19, 1988

**LOCAL EDUCATION AGENCY (LEA) DESIGNEE**

DESIGNEE NAME: Billy H. Clemmons  
ADDRESS: P. O. Box 129 Brownsville, KY 42210  
PHONE NO.: (502)597-2172

TRAINING AGENCY: University of Kentucky  
TRAINING COURSE: Asbestos Management Planner  
DATE (S) TAKEN: 2/15-19/88 NO. HOURS IN COURSE: 40

**DOCUMENT SUMMARY**

- ☒ 1.0 COVER SHEET  
☒ 2.0 SCHOOLS  
☒ 3.0 RESPONSE ACTIONS MANAGEMENT PLANNER RECOMMENDATIONS  
ONE (1) FORM FOR EACH SCHOOL  
☒ 3.1 RESPONSE ACTION DETAILED ACTION TO BE TAKEN BY LEA  
ONE (1) FORM FOR EACH RESPONSE ACTION  
☒ 4.0 FOLLOW-UP ACTIONS  
ONE (1) FORM FOR EACH SCHOOL

- ☒ 5.0 SCHOOL INFORMATION FORM  
ONE (1) FORM FOR EACH SCHOOL  
☒ 6.0 HOMOGENEOUS AREA (HA) FORM  
ONE (1) FORM FOR EACH HOMOGENEOUS AREA  
☒ 6.1 HOMOGENEOUS AREA DRAWING  
ONE (1) DRAWING FOR EACH HOMOGENEOUS AREA  
☒ BULK SAMPLE LOG  
☒ BULK SAMPLE ANALYSIS

THE SIGNATORIES BELOW CERTIFY THAT THE LOCAL EDUCATION AGENCY RESPONSIBILITIES, AS STIPULATED IN USEPA 40 CFR PART 763.84 HAVE BEEN MET OR WILL BE MET.

*Billy H. Clemmons* 10/12/88  
LEA AHERA DESIGNEE SIGNATURE DATE

*David L. Webb* 10/12/88  
LEA SUPERINTENDENT SIGNATURE DATE

**AGENCY REVIEW**

NOTES: \_\_\_\_\_  
\_\_\_\_\_  
\_\_\_\_\_  
\_\_\_\_\_  
\_\_\_\_\_

ACCEPTED ☐RETURNED FOR REASONS STATED ☐**COVER SHEET**

AHERA MANAGEMENT PLAN - KENTUCKY SCHOOLS

AS REQUIRED UNDER  
ASBESTOS HAZARD EMERGENCY RESPONSE ACT OF 1986 (AHERA)  
US ENVIRONMENTAL PROTECTION AGENCY REGULATIONS  
(40 CFR PART 763 SUBPART E Asbestos-Containing Materials in Schools)

LEA: Edmonson County Schools 151  
LEA NAME LEA NO.  
ADDRESS: P. O. Box 129 Brownsville, KY 42210  
SUPERINTENDENT: David L. Webb  
PHONE: (502)597-2191

10/12/88  
MANAGEMENT PLAN DATE